

**AGENDA OF ORDINARY MEETING OF YARRIAMBIACK SHIRE COUNCIL TO BE HELD  
ON WEDNESDAY 27 APRIL 2016 AT THE MUNICIPAL OFFICE 34 LYLE STREET  
WARRACKNABEAL AT 9:30AM**

---

**1 WELCOME**

**2 ACKNOWLEDGEMENT**

We acknowledge the traditional owners of the land on which we meet today and pay our respect to both past and present elders.

**3 PRAYER**

*Almighty God, without whom no Council can stand nor anything prosper we ask that you be present and guide us in our deliberations today. We pray that we will be fair in our judgements and wise in our actions and that decisions will be made with goodwill and a clear conscience for the betterment and welfare of the people of Yarriambiack Shire.*

*Amen*

**4 PRESENT**

Cr R Kingston, Cr T Grange, Cr A McLean, Cr K Zanker, Cr H Ballentine, Cr G Massey, Cr L Woods, Ray Campling (Chief Executive Officer), James Magee (Director Infrastructure & Planning) and Bernardine Schilling (Executive Assistant)

**5 APOLOGIES**

**6 CONFIRMATION OF MINUTES**

Ordinary Meeting of Council – 23 March 2016

**7 DECLARATION OF CONFLICT OF INTEREST**

## **8 BUSINESS ARISING**

**8.1 Action List from last meeting**

**8.2 Ongoing and Pending Action List**

## **9 PETITIONS**

## **10 REPORTS**

### **Corporate Reports**

- 10.1 Mayor's Report
- 10.2 Councillor's Reports
- 10.3 Chief Executive Officer – Activity Report
- 10.4 Director Infrastructure & Planning Report
- 10.5 Capital Works Program Report
- 10.6 Community Services Report
- 10.7 Infrastructure Services Report
- 10.8 Community Projects Report

## **11 REPORTS FOR DECISION**

- 11.1 Finance Report
- 11.2 Revenue Report
- 11.3 SHARE Community Grants January – April 2016
- 11.4 Town Planning Application Report TP 69-15 Gypsum Extraction Pit
- 11.5 Town Planning Application Report TP 07-16
- 11.6 Speed Limit on Henty Highway at Brim – Prepared by James Magee

**10.1 Mayor's Report – Prepared by Ray Kingston**

28 March	Attended opening of Rupanyup and District Men's Shed
06 April	Attended Premiers and Ministers announcements at Longerenong College
06 April	Attended BBQ with Premier and Ministers and Victorian Farmers Federation (VFF) in Wycheproof
07 April	Attended Breakfast with Premier and Ministers at Lake Tchum
11 April	Met with Project Manager of Lighting the Regions. Bendigo
14 April	Chaired Lighting the Regions meeting in Horsham
15 April	Attended Longerenong College Graduation
18 April	Facilitated Woomelang Community Plan Update for WDDA
20 April	Attended H3O lunch and presentation at Warracknabeal
20 April	Attended E-Rup meeting at Rupanyup
20 April	Chaired Triennial General Meeting of Jung Recreation Reserve
22 April	Attended Seasonal Conditions meeting in Horsham
22 April	Attended Murtoa Lions Club Debutante Ball
24 April	Attended Skate Park Leagues Event at Warracknabeal
25 April	Attended Rupanyup ANZAC Day Service

**10.2 Councillor's Reports****Cr H Ballentine**

- 07 April Accepted invitation for breakfast at Tchum Lake with Jaala Pulford MP, Lisa Neville MP, & the Premier Daniel Andrews and the Mallee Catchment Management Authority drought workers
- 13 April Attended Council Forum in Warracknabeal
- 14 April Attended the Rural Industries Research & Development Corporation Award at Parliament House and lunch at Farrer House
- 16 April Performed a small ceremony at Hopetoun Cemetery to recognise the handover of a silver medallion that had been lost for 101 years, belonging to Cr John Turriff of Karkaroc
- 20 April Attended the GMMWater stakeholder meeting at Grains Innovation Centre in Horsham
- 22 April Attended the Seasonal Drought Committee Meeting in Horsham

**Cr G Massey**

- 25 March Opened Y/Fest Art Show
- 25 March Launched Arts Council new brochure 'Warracknabeal Walkabout Art'
- 06 April Attended special general meeting at Warracknabeal Senior Citizens
- 11 April Chaired Warracknabeal Town Hall Committee AGM. Also attended by Cr K Zanker and CEO Ray Campling
- 12 April Attended Warracknabeal Action Group meeting
- 13 April Council Forum
- 15 April Attended Wimmera Regional Library Corporation meeting at Stawell
- 25 April Attended ANZAC Day Services at Sheep Hills, Rupanyup and Murtoa
- 26 April Attended special meeting Warracknabeal Action Group and Historical Society to plan Warracknabeal's 150<sup>th</sup> Anniversary in 2017

**Cr K Zanker**

- |          |   |
|----------|---|
| 26 March | Attended the Y/Fest Easter Parade at Warracknabeal  |
| 31 March | Attended the Rural Financial Counselling Services general meeting in Mildura                                |
| 02 April | Attended the Wheat City Derby Angels first Scrimmage in Warracknabeal and welcomed Andrew Broad             |
| 04 April | Attended the "Duck Cameron" magician hosted by the Wimmera Regional Library Corporation                     |
| 11 April | Attended the Warracknabeal Town Hall AGM with CEO Ray Campling and Cr Massey                                |
| 13 April | Attended the official launch of the shared building with the SES and Volunteering Western Victoria in Nhill |
| 13 April | Council Forum   |
| 16 April | Attended the Endoreic short film presentation and awards night at Lake Lacelles                             |
| 20 April | Attended Volunteering Western Victoria general meeting  |
| 20 April | Attended the HUB general meeting  |
| 25 April | Attended the Anzac Day Wreath Laying Services at Brim and Warracknabeal                                     |

**Cr L Woods**

- 25 – 27 March            Attended the Y/Fest weekend in Warracknabeal
- 13 April                    Attended Council Forum

**Cr A McLean**

- 23 March                    Participated in the SHARE Grants Evaluation panel
- 06 April                    Attended BBQ tea at Wycheproof put on by the VFF for the return visit by the Premier, Minister for Agriculture and the Minister for Water. Review of the drought situation and for further funding announcements
- 08 April                    Attended Audit and Board meetings of the Grampians Central West Waste and Resource Recovery Group at Horsham
- 12 April                    Attended the presentation of DLWEP's draft Biodiversity Strategy in Horsham
- 13 April                    Attended Council Forum at Warracknabeal
- 18 April                    Attended the Community Planning Workshop at Woomelang
- 20 April                    Attended GMMWater's Stakeholder Workshop in Horsham
- 22 April                    Attended the Seasonal Conditions Meeting in Horsham
- 25 April                    Attended the ANZAC Day Service at Patchewollock

YARRIAMBIACK SHIRE COUNCIL

COUNCIL MEETING

AGENDA

27 APRIL 2016

---

**Cr T Grange**

- |             |  |
|-------------|--|
| 23 April    | Formal Council meeting   |
| 23 April    | Attended the SHARE evaluation committee meeting at Warracknabeal                           |
| 25-28 April | Easter holidays  |
| 01 April    | Attended WSMRTG committee meeting in Horsham   |
| 02 April    | Attended the reception for Murray to Moyne local cyclists at Murtoa                        |
| 05 April    | Chaired the MEMPC meeting at Warracknabeal   |
| 12 April    | Met with Kate Rose Henry from Minyip Shocking Arts Group - various issues at Warracknabeal |
| 12 April    | Attended the Wimmera Development Association board meeting in Horsham                      |
| 13 April    | Council Forum  |
| 14 April    | Met with Dennis Smith from Council – various issues at Minyip                              |
| 19 April    | Attended Murtoa Progress Meeting at Murtoa   |
| 20 April    | Attended the H30 luncheon and presentations at Warracknabeal                               |
| 22 April    | Attended the Wimmera Highway Action Committee meeting in Stawell                           |
| 25 April    | Attended Murtoa Anzac Day Service at Murtoa  |
| 25 April    | Attended the Minyip RSL Anzac Day Service at Minyip  |

**10.3 Chief Executive Officer, Activity Report – Prepared by Ray Campling**

- Attended Violence Against Women Regional Strategy meeting in Horsham
- Attended Melissa Mitchell – Woomelang Primary School Principal last day farewell luncheon
- Attended the official opening of Y/Fest at the Warracknabeal Arts Council function
- Attended the official opening of the Warracknabeal Community Gardens in Scott Street
- Attended various Y/Fest activities including the Street Parade, Wheatland's Museum and the Warracknabeal races
- Attended the official opening of the Rupanyup Men's Shed at the Wood's Museum
- Met with Wimmera Development Association Executive Officer, Ralph Kenyon – various matters
- Attended Grampians Regional Management Forum in Ararat
- Met with Gary Norton – Chair North West Municipalities Association – NWMA Agenda
- Attended Victorian Farmers Federation BBQ function at the Wycheproof Golf Club where the Premier Daniel Andrews, Ministers Jaala Pulford and Lisa Neville announced various drought funding projects. The following day attended a Drought Employment breakfast which involved Premier Daniel Andrews, Ministers Jaala Pulford and Lisa Neville was held at Lake Tchum, near Birchip
- Met with Wayne Street in Gisborne in relation to the Rupanyup office proposal
- Attended Rural Council's Victorian Executive meeting in Melbourne
- Attended Wimmera Development Association meeting in Horsham
- Attended Warracknabeal Town Hall AGM
- Attended Wimmera CEO's meeting at Stawell
- Attended 'Endoreic' Short Film Festival at Lake Lascelles
- Attended the Wheat City Derby Angels first scrimmage in the W'Beal Leisure Centre
- Met with Mark Hogan, Regional Development Victoria – funding programs



YARRIAMBIACK SHIRE COUNCIL

COUNCIL MEETING

AGENDA

27 APRIL 2016

---

- Attended 'Building Resilience In Farming' Information sessions in St. Arnaud and Brim
- Attended H30 Challenge lunch at the ANZAC Park Community Centre
- Attended E-Rup meeting in relation to the Rupanyup office proposal
- Chaired Wimmera Southern Mallee LLEN meeting at Federation University
- Attended ANZAC Day Service at Warracknabeal and Brim

**10.4 Director Infrastructure & Planning Report – Prepared by James Magee****Community Cash Contribution for Mobile Phone Tower at Yaapeet**

The Yaapeet Community have advised they will contribute \$20,000 cash toward a mobile phone tower at Yaapeet. This should be a tremendous boost to the project as Council has already nominated a \$10,000 cash contribution as well as a \$10,000 in kind contribution.

**School Crossing Proposed for Hopetoun**

The Hopetoun P12 School has commenced the 2016 school year with both primary and secondary students located at the Dodgshun Street (formerly high school) campus and as such a school crossing has been requested. The proposal was circulated to affected landowners and no objections were received. The works are expected to commence during the next month.

**V/LINE Bus Stop Murtoa**

The new bus stop on the southern side of Marma Street is complete.

**Aerodrome Lighting Upgrade**

The replacement of the lighting at Warracknabeal Aerodrome is 50% complete. Replacement of lights at Hopetoun Aerodrome will follow with works expected to be complete at both aerodromes by mid June. The Automatic Weather Station at Warracknabeal will also be installed during this period...

**Environment – Prepared by Geoff Harvey**

- Inspected problem trees and provided advice to Murtoa College staff
- Inspected trees on Dimboola-Minyip Road prior to construction work
- Organised and conducted tree propagation training for Green Army team
- Organised and attended Yarriambiack Creek Advisory Committee meeting at Hopetoun
- Organised removal of Silver leaf nightshade from Yarto East Road
- Green Army tree planting at Warracknabeal tip
- Inspected section of Minyip-Dimboola Road re vegetation issues
- Attended Green Army planning meetings
- Ongoing management of Green Army program

**Risk & Safety Report to Council – Prepared Barry Sullivan**

- The Community Service Department are currently conducting testing and tagging of electrical items in community service buildings throughout the Shire. Information is recorded (*as it comes into the office*) on a central database, master copy folder and field folder. A request from the building surveyor and building department has resulted in the development of information sheets for builders and community members planning and managing building projects. The information sheets cover the mandatory health and safety requirement when setting up and running a building project. Once accepted by the building team it will be developed into a safety information booklet for all community groups to use
- Recording and sending out letters to those reporting incidents
- Reviewing the risk assessments area of event applications as they arrive
- Currently compiling the results of the office safety audit. The results of the audit will be discussed at the office designated working group meeting and any outstanding health and safety issues will be developed into recommendations to management
- Attended the bi-monthly OHS committee meeting. A number of actions within the Community Services Department have been solved & completed
- Invited to a Worksafe information session in Horsham. The session was attended by mostly management and office staff from surrounding government and business organisations. Information session focused around mental health in the workplace, return to work and Workcover insurance.
- Safety meeting at the Warracknabeal Leisure Centre. The discussion related to a sporting group who intends to start training sessions there. Building inspector and I to meet with the Leisure Centre manager to discuss further safety systems to minimise injury.
- Inspected skate park ramps with Murray McKenzie to discuss any safety issues prior to SPL Skate Park League Workshops. A risk assessment is to be completed prior to the event.
- Chemicals used for controlling pest plants & animals by council staff as well as contractors engaged by council will now be recorded on a central database.



**10.5 Capital Works Program 2015/2016 – Prepared by Chris Lehmann**

<b>Roads &amp; Streets – Urban Roads</b>				
<b><i>Project</i></b>	<b><i>% Completed</i></b>	<b><i>Start Date</i></b>	<b><i>Completion Date</i></b>	<b><i>Comments</i></b>
Brock Street Woomelang		May 2016		Improve median strip with new tree and turning areas
Cemetery Road Warracknabeal	100%	February 2016	February 2016	Construct and seal 4 metres wide, 200 metres long from Anderson Street heading west (near Mens Shed)
Cook Street Woomelang	100%	April 2016	April 2016	Construct and seal 5.5 metres wide, Roberts Street to Church Street
Gould Street Warracknabeal	100%	February 2016	February 2016	Construct and seal 7 metres wide Cox Street to Allan Street
Long Street Warracknabeal	100%	February 2016	February 2016	Construct and seal 4 metres wide Dungey Street to Dally Street
Market Street Minyip	100%	March 2016	March 2016	Construct and seal shoulder 2.5 metres wide Foundry Street to McLeod Street
Mill Street Minyip	100%	July 2015	August 2015	Willmores
Roberts Street Woomelang	100%	April 2016	April 2016	Construct and seal 5.5 metres wide, Brock Street to Cook Street
Scott Street Warracknabeal	100%	February 2016	February 2016	Construct and seal 15 metres wide at Arnold Street intersection
Smith Street Warracknabeal	100%	February 2016	February 2016	Construct and seal 4 metres wide from Dungey Street
Taylor Street Warracknabeal	100%	January 2016	January 2016	Construct and seal 4 metres wide Anderson Street to Secondary College

<b>Roads &amp; Streets – Rural Roads</b>				
<b><i>Project</i></b>	<b><i>% Completed</i></b>	<b><i>Start Date</i></b>	<b><i>Completion Date</i></b>	<b><i>Comments</i></b>
Banyena Pimpinio Road R2R	100%	October 2015	December 2015	Reconstruct and widen seal to 6.6 metres, total distance 2.8 kms (2 jobs). Job starts at Murtoa Minyip Road heading east
Brim West Road R2R	100%	December 2015	December 2015	Reconstruct seal (4 metres), two sections, total distance 2.86 kms. Job between Fishers Road and Warracknabeal Rainbow Road
Dimboola Minyip Road	100%	March 2016	April 2016	Reconstruct seal to 6.6 metres, length 1.2 kms, works start at Barrat Quarry Road heading east
Gama Sea Lake Road R2R	100%	March 2016	April 2016	Reconstruct seal 4 metres, length 2 kms, section starts east of Lascelles North Road heading east
Longerenong Road	100%	February 2016	February 2016	Widen seal to 6.6 metres for 1.94 kms. Starting point 3 kms from Murtoa Glenorchy Road
Patchewollock Tempy Road R2R	100%	September 2015	November 2015	Construct 6.6 metre seal, length 1.5 kms, starts end of seal Patchewollock end
Sea Lake Lascelles Road R2R	60%	April 2016		Reconstruct seal 6.6 metres, length 1.3 kms, starts at Shire boundary heading west

<b>Roads &amp; Streets – Rural Roads (continued)</b>				
<b><i>Project</i></b>	<b><i>% Completed</i></b>	<b><i>Start Date</i></b>	<b><i>Completion Date</i></b>	<b><i>Comments</i></b>
Watchem Warracknabeal Road R2R	100%	September 2015	October 2015	Reconstruct seal to 5.5 metres, length 1.6 kms. Starting 400 metres east of Rupanyup Road and going east
Sheep Hills Bangerang Road R2R	100%	January 2016	February 2016	Construct 4 metre seal, 1.4 kms long, starting end of seal heading north

<b>Gravel Shoulders</b>				
<b><i>Project</i></b>	<b><i>% Completed</i></b>	<b><i>Start Date</i></b>	<b><i>Completion Date</i></b>	<b><i>Comments</i></b>
Banyena Pimpinio Road		March 2016		Construct 2 metre wide sandstone shoulder both sides of seal. 2 sections, total length 2.7 kms
Brim West Road R2R	100%	March 2016	March 2016	Construct 2 metre wide sandstone shoulder both sides of seal, 3.4 kms long (either side of Hood Lane)
Dimboola Minyip Road		April 2016		Construct 2 metre wide sandstone shoulder both sides of seal, 1 km long
Hopetoun Yaapect Road	100%	December 2015	January 2016	Construct 2 metre wide limestone shoulder both sides of seal, 3.2 kms in length (either side of Websters Road)
Minyip Dimboola Road	100%	April 2016	April 2016	Construct 2 metre wide sandstone shoulder both sides, 500 metres in length
Minyip Rich Avon Road	40%	April 2016		Construct 2 metre wide sandstone shoulder both sides of seal, 1.6 kms in length

<b>Gravel Shoulders (continued)</b>				
<b><i>Project</i></b>	<b><i>% Completed</i></b>	<b><i>Start Date</i></b>	<b><i>Completion Date</i></b>	<b><i>Comments</i></b>
Rosebery Rainbow Road		May 2016		Construct 2 metre wide limestone shoulder both sides of seal, 1 km in length (near Kemp's Road)
Rupanyup Road R2R	100%	November 2015	November 2015	Construct 2 metre wide sandstone shoulder both sides of seal. 2 sections, total length 8.5 kms
Sea Lake Lascelles Road	100%	April 2016	April 2016	Construct 2 metre wide limestone shoulder both sides of seal, 1 km in length (east of Maxwells Road)
Sheep Hills Bangerang Road	100%	February 2016	February 2016	Construct 2 metre wide sandstone shoulder both side of seal, 2.1 kms in length
Wyperfeld Park Road		May 2016		Construct 2 metre wide limestone shoulder both sides of seal, 1.5 kms in length (south of Mitchells Road)
Yaapeet Kenmare Road		May 2016		Construct 2 metre wide limestone shoulder both sides of seal, 1.6 kms in length (south of Hopetoun Rainbow Road)



<b>Gravel Re-Sheets</b>				
<b><i>Project</i></b>	<b><i>% Completed</i></b>	<b><i>Start Date</i></b>	<b><i>Completion Date</i></b>	<b><i>Comments</i></b>
3LK Road		May 2016		Construct 4 metre wide road, 510 metres in length using Great Western Gravel
A Matthews Road		April 2016		Construct 5 metre wide road, 920 metres in length using St Arnaud Gravel
Ailsa Road	100%	October 2015	October 2015	Construct 5 metre wide sandstone road, 1.29 kms in length
Ailsa Wheat Road	100%	November 2015	November 2015	Construct 4 metre wide sandstone road, 1.17 kms in length
Antwerp Road		April 2016		Construct 4 metre wide sandstone road, 440 metres in length
Areegra Exchange	100%	August 2015	August 2015	St Arnaud Gravel
Averys Road	100%	August 2015	August 2015	Hewitts Pit Sandstone
Bangerang Hall Road	100%	July 2015	July 2015	Hewitts Pit Sandstone
Boolite Donald Road	100%	February 2016	February 2016	Construct 5 metre wide road using St Arnaud Gravel
Boundary Road 2		May 2016		Construct 5 metre wide limestone road, 2.26 kms in length
C Readings Road		May 2016		Construct 4 metre wide road, 1 km in length using Great Western Gravel
Cannum 5 Chain Road		June 2016		Construct 5 metre wide sandstone road, 2.5 kms in length
Clyne Road		June 2016		Construct 4 metre wide sandstone road, 1.5 kms in length
Dogwood Road		May 2016		Construct 4 metre wide sandstone road, 1.8 kms in length

## YARRIAMBIAK SHIRE COUNCIL

COUNCIL MEETING

AGENDA

27 APRIL 2016

<b>Gravel Re-Sheets (continued)</b>				
<b><i>Project</i></b>	<b><i>% Completed</i></b>	<b><i>Start Date</i></b>	<b><i>Completion Date</i></b>	<b><i>Comments</i></b>
Echunga Road	100%	February 2016	February 2016	Construct 4 metre wide limestone road, 970 metres in length
Feerys Road	100%	February 2016	February 2016	Construct 4 metre wide sandstone road, 810 metres in length
Gama South Road		June 2016		Construct 4 metre wide limestone road, 960 metres in length
Goslings Road	100%	July 2015	July 2015	Eys Pit Limestone
Guleys Road		May 2016		Construct 4 metre wide limestone road, 1 km in length
Hoffmans Road	100%	August 2015	August 2015	Murphys Pit Sandstone
Hollands Road	100%	August 2015	August 2015	Hewitts Pit Sandstone
Holtkamps Road	100%	July 2015	July 2015	Chapmans Pit Sandstone
Jollys Road	100%	April 2016	April 2016	Construct 4 metre wide limestone road, 1.5 kms in length
Lah Angle Road	100%	August 2015	August 2015	Hewitts Pit Sandstone
Lascelles North Road	100%	September 2015	September 2015	Construct 4 metre wide limestone road, 4.4 kms in length R2R funding
Lawler Carron Road	100%	July 2015	July 2015	Construct 4 metre wide road using St Arnaud Gravel
McIntyres Road		May 2016		Construct 4 metre wide road, 600 metres in length using Great Western Gravel
Mellis Road	100%	January 2016	January 2016	Construct 4 metre wide road, 2.3 kms in length using St Arnaud Gravel
Moloneys Road		May 2016		Construct 4 metre wide sandstone road, 2.6 kms in length

<b>Gravel Re-Sheets (continued)</b>				
<b><i>Project</i></b>	<b><i>% Completed</i></b>	<b><i>Start Date</i></b>	<b><i>Completion Date</i></b>	<b><i>Comments</i></b>
Murtoa Cemetery Road	100%	July 2015	July 2015	Chapmans Pit Sandstone
Niewands Road		June 2016		Construct 4 metre wide sandstone road, 1.5 kms in length
Olneys Road		April 2016		Construct 4 metre wide road, 460 metres in length using St Arnaud Gravel
Patchewollock Tip Road	100%	October 2015	November 2015	Construct 4 metre wide limestone road, 380 metres in length
Pullens Road		May 2016		Construct 4 metre wide sandstone road, 1.6 kms in length
Ratray Road	100%	August 2015	August 2015	Hewitts Pit Sandstone
Rosebery Rainbow Road		April 2016		Construct 4 metre wide limestone road, 500 metres in length
Thompsons Road	100%	August 2015	August 2015	St Arnaud Gravel
Turriff West Road		May 2016		Construct 5 metre wide limestone road, 1.9 kms in length
Two Mile Road		June 2016		Construct 4 metre wide limestone road, 2.6 kms in length
V Schultzs Road	100%	January 2016	January 2016	Construct 4 metre wide sandstone road, 760 metres in length
Wallup Hall Road		June 2016		Construct 4 metre wide sandstone road, 2.7 kms in length
Wardles Road West	100%	August 2015	August 2015	Murphys Pit Sandstone
Wathe Reserve Road	100%	April 2016	April 2016	Construct 4 metre wide limestone road, 860 metres in length
Woods Road		May 2016		Construct 4 metre wide road using St Arnaud Gravel

<b>Gravel Re-Sheets (continued)</b>				
<b>Project</b>	<b>% Completed</b>	<b>Start Date</b>	<b>Completion Date</b>	<b>Comments</b>
Woollards Road	100%	October 2015	October 2015	Construct 4 metre wide limestone road, 1.8 kms in length
Yaapeet South Road	100%	January 2016	January 2016	Construct 5 metre wide limestone road, 2.5 kms in length
Yarto Speed Road		April 2016		Construct 4 metre limestone road, 3.2 kms in length

<b>Footpaths</b>				
<b>Project</b>	<b>% Completed</b>	<b>Start Date</b>	<b>Completion Date</b>	<b>Comments</b> <i>Works part of contract</i>
Beggs Street Warracknabeal		April 2016		Section 1 - Construct 1.5 metre concrete footpath starting at O'Brien Street towards King Street (107 metres) Section 2 - Werrigar Street to O'Brien Street (72 metres)
Craig Avenue Warracknabeal		April 2016		Construct 1.5 metre concrete footpath starting at 80 Craig Avenue to Kokoda Avenue (137 metres)
Lyle Street Warracknabeal		May 2016		Construct 1.5 metre concrete footpath Molyneaux Street to Devereux Street (108 metres)
Lascelles Street Hopetoun	100%	March 2016	April 2016	Construct 1.5 metre concrete footpath from Police Station to Strachan Street (79 metres)

<b>Footpaths</b>				
<b>Project</b>	<b>% Completed</b>	<b>Start Date</b>	<b>Completion Date</b>	<b>Comments</b> <i>Works part of contract</i>
Cromie Street Rupanyup		May 2016		Construct 1.5 metre footpath from Woods Street going north (110 metres long)
Main Street Minyip	100%	April 2016	April 2016	Construct 1.5 metre footpath from 139 Main Street to Walking Track (53 metres)
O'Brien Street Warracknabeal		May 2016		Construct 1.5 metre concrete footpath from Campbell Street to Beggs Street (102 metres)
Phillips Street Warracknabeal		May 2016		Construct 1.5 metre concrete footpath on south side of Wheatlands Warehouse (32 metres)
Strachan Street Hopetoun	100%	March 2016	March 2016	Construct 1.5 metre concrete footpath from Toole Street to gate at Recreation Reserve (115 metres)
Hewitt/Bell Streets Warracknabeal				Pedestrian Crossing
Scott/Bell Streets Warracknabeal				Pedestrian Crossing
Scott/Milbourne Streets Warracknabeal				Pedestrian Crossing

<b>Kerb &amp; Channel</b>				
<b>Project</b>	<b>% Completed</b>	<b>Start Date</b>	<b>Completion Date</b>	<b>Comments</b> <i>Works part of Contract</i>
Cromie Street Murtoa	100%	March 2016	April 2016	Renew kerb and 4 metre sealed road (Marma to Breen Street)
Dennys Street Hopetoun	100%	August 2015	September 2015	Willmores
Foundry Street Minyip		June 2016		Section 1 - Renew kerb and seal up to kerb (Main to Market Street) Section 2 - Renew kerb and seal to new kerb (Wimmera to Main Street)
McLeod Street Minyip		May 2016		Renew and add new kerb and seal to new kerb (Main to Market Street)
Stewart Street Rupanyup	100%	September 2015	February 2016	Renew kerb and underground drainage and seal up to new kerb

<b>Bridges &amp; Culverts and Drainage</b>				
<b>Project</b>	<b>% Completed</b>	<b>Start Date</b>	<b>Completion Date</b>	<b>Comments</b>
Lloyd/Munro Streets Murtoa				Drainage – Install Pipe & Storm Water Pit
Gladstone Street Beulah				Renew Culverts
Lloyd/Munro Streets Murtoa				Upgrade Drainage System
Phillips Street Beulah				Renew Culverts

Tree Lopping  
Line Marking  
R2R Signage

## 10.6 Community Services Report – Prepared by Gavin Blinman

### Kindergartens

Finalising enrolment DATA for our first census at the moment, all children will be counted as KSF and receive the drought funding of \$1,386. Once we have sent data to Department of Education & Training we will meet with committees at kindergarten to work out how we pay the money directly to each kindergarten.

### Environmental Health / Local Laws – Prepared by Tim Rose & Greg Wilson

All food business registrations have been completed for the 2016 period. Inspections have continued, however, numbers have been lower than normal due to the introduction and adjustment to new inspection software. This software will make the inspection process significantly more time efficient and proprietors will receive their report directly to their email.

Council successfully completed a prosecution under the *Food Act 1984* where a business repeatedly failed to comply with officer directions in accordance with the Food Standards Code. The proprietor pleaded guilty to two consolidated charges in the Hopetoun Magistrates Court on 7 April 2016. The Magistrate ordered an aggregate fine of \$7,500 and awarded costs in Council's favour in the sum of \$2,500. Council hopes that this significant penalty will encourage other proprietors to ensure they are selling safe and suitable food.

Routine Blue Green Algae monitoring ceased at the end of March as per Council's BGA Policy. Samples revealed that BGA levels in Lake Lascelles did not pose a risk to public health and the signage was removed several weeks ago. Sampling will continue in Lake Marma until the BGA levels are recorded below safe levels and at that time, all signage can be removed.

An aged care facility experienced a gastro outbreak that affected both residents and staff. Council was notified of the event by the Department of Health. Council provided outbreak control advice and corrected any areas where deficiencies were identified. Council completed two inspections of the facility to ensure the risk of further cases were minimised. The staff was cooperative and efficient and the outbreak was declared over in less than one week. All control measures were lifted following 48hrs from the last symptom.

Onsite wastewater permits remain constant. The final permits for CFA station toilets are nearly completed, with Council requiring some final documentation in order for these sites to be completed. A number of people have been brought to Council's attention due to the fact that they are not servicing their onsite sewage systems as per their permit conditions. These people will receive a letter from Council and if servicing does not occur, there will be few options but to issue infringement notices.

It has been another busy month with cats and local law issues dominating once again. The situation in Livingstone Street, Warracknabeal has and continues to take up a considerable amount of time with some compliance and more to come.

Cat issues in Minyip and Murtoa are still ongoing, with many sick cats and kittens in one location being a major issue. RSPCA have been involved, however the inspector from Ballarat has gone on stress leave. We have been informed it will be 6 months before they have a new inspector. This is not unusual but it does make it extremely hard for us in getting help with these types of jobs, as getting an inspector up from Melbourne is not an easy task.

Dog issues have been quiet with only a small number of complaints re wandering dogs, thankfully no serious issues.

Animal registrations have gone out and those that have not been registered are now overdue. A door knocking program will start in the coming weeks for unregistered animals.

## **Aged and Disability – Prepared by Lisa Dunkley**

### **Memory Strategies Group**

Recently the Yarriambiack Shire Council held two Memory Strategies Group sessions. First session was held on Thursday, 31 March in Minyip at the Senior Citizen Club Rooms and followed by Friday, 1 April at Hopetoun Senior Citizen Club Rooms. Minyip was well attended with 18 people attending, however Hopetoun only had four people attend with many apologies. Katie Ramsdale – Memory Support Nurse from Rural Northwest Health was guest speaker for both sessions. Katie brought along strategies and equipment that the community could use within their homes and plenty of knowledge regarding memory issues. It also gave those who attended awareness what Katie's role is and how they could reach out to her if needed. Feedback from those that attended the sessions was that they thoroughly enjoyed what Katie shared with the group and looking forward to more sessions later in the year.

## **Volunteer Meals and Transport – Prepared by Michelle Hallam**

### **Transport**

For the month of March 2016 Shire completed 17 drives and had two cancellations. This month elderly were mainly accessing services in Horsham. The table below is a comparison over the last three years.

<b>March 2016</b>	17 drives, 2 cancellations
March 2015	12 drives
March 2014	9 drives

### **Meals on Wheels**

\*Please note public holidays have impacted totals.

<b>March 2016</b>	824 Meals
March 2015	1,227 Meals



**Maternal and Child Health (MCH) – Prepared by Nanette Freckleton and Michelle Schilling**

- 50 Birth Notifications for the year so far
- 61 enrolments
- Immunisation sessions monthly well attended
- Lets Read volunteers continue to attend these sessions in Warracknabeal
- Next round of school immunisations will be in May
- CDIS computer program becoming more user friendly with tweaking by the DRA in conjunction with MAV, still some issues

**Youth Report – Prepared by Murray McKenzie**

- Skate Workshops were well attended 3 April. It was pleasing to see our Skate Parks being used
- Members of the Yarriambiack Youth Action Council met Wednesday, 13 April 2016. Central to discussions were support of Young Achiever Awards and the Endoreic Film Festival on Saturday night 16 April, both events are trekking well. Also Skate Event the following week 24 April 2016
- Discussion also on involvement with Seasons of Wellness and efforts to increase knowledge about Mental Health-potentially an event to bring focus on the positive things in the Shire from a young persons perspective, and bring youth and parents guardians closer together
- FReeZA events discussed look like being potentially battle of the bands and a skate event for Murtoa, Warracknabeal has the skate event and possibly Yarriambiack Has Talent. Hopetoun events being discussed with Hopetoun SRC to get buy in
- FReeZA events also supported the Roller Derby Event as well as the “Young Masters” Hip Hop Break Dance Group which visited Murtoa College and Warracknabeal College during National Youth Week - we obviously had our Young Achiever Awards
- Gaming nights to ramp up after April Media coverage and stories have been a lot more positive on Youth Involvement in the Community

**SHARE Program 'Sustainable Healthy Adaptable Resilient Engaged' – Prepared by Marianne Ferguson****Brim Public Amenities Upgrade**

The Brim Public Amenities are now open for public use.

**Community Group Financial Assistance Scheme**

The Community Assistance Grants are currently open and will close on 6 May, 2016. These grants are to assist with the maintenance and capital improvements of community assets and events and community groups can apply for a maximum of \$500.

**Community Planning Forums**

A Community Planning Forum facilitated by Mayor Ray Kingston was held in Beulah on Monday March 21 and was well attended. The community discussed and tabled projects to be included in the Beulah Community Action Plan. At the time of this report, the Woomelang Community Planning Forum will be held on Monday, 18 April 2016.

**Rupanyup Signage**

Advance awareness road signs for Woods' Farming and Heritage Museum are currently being developed to attract additional travellers to stop at the site. Initial Vicroads approval has been confirmed.

**Small Towns Transformation**

The Murtoa Progress Association, Hopetoun Progress Association and Woomelang and District Development Association were unsuccessful with their expressions of interest to Regional Arts Victoria Small Towns Transformation funding program.

**Warracknabeal Nick Cave Signage**

Birthplace of Nick Cave signage has been installed at the entrances of Warracknabeal on the existing arch welcome signs. The Warracknabeal Arts Council is continuing to develop ideas to promote and celebrate musician Nick Cave.

**Wimmera Mallee Tourism**

The Wimmera Mallee region will be featured on an upcoming episode of Chanel 7's Travel Oz TV show. Filming will be taking place in late April.

**Yarriambiack Tourism**

The next Yarriambiack Tourism Meeting will be held on May 2, at the Mallee Sunset Gallery in Rosebery. The Yarriambiack Tourism Facebook Page currently has 1,292 'Likes'. A brochure is currently being developed for the Murtoa Heritage Trails. The Beulah brochure is currently being altered for reprint. The Hopetoun brochure has been reprinted. Yarriambiack Tourism is currently working with Juddy Roller, a Melbourne Street Art company to develop destination posters for numerous locations around the Shire. This project is in the initial stages.

## **10.7 Infrastructure Services Report – Prepared by Bernie Naylor**

### **Asset Engineer – Mick Evans**

- Completed Council's renewal gap report
- In conjunction with the design engineer, gather information from the community group meeting, to adjust the design of the Warracknabeal proposed patient transfer station and assist funding applications
- Updated the road asset register with data from the latest round of safety inspections as per the Road Management Plan
- Assisted the IT Consultant with IT issues in the Technical Services Department after the virus shut down Council's computer network
- In conjunction with the design engineer, assist the community groups with drawing design for the Warracknabeal aerodrome transfer station
- Attended the shared services GIS working group meeting in Horsham
- Begun setting up and implementing the GIS shared services data and associated websites
- Completed the budget for Technical Services Department
- In conjunction with the contractor help coordinate the renewal project of the lighting at Warracknabeal aerodrome
- Participated in the AAA Small Regional Aerodromes Networking Teleconference Victoria & Tasmania

### **OH&S and Risk Management**

- Participated in a OH&S software webinar
- Attend and chaired the Council's OH&S meeting

### **Emergency Management**

- Developed a report for the Municipal Emergency Management Planning Committee (MEMPC) meeting
- Attended the MEMPC meeting

### **Design Engineer – Joel Turner**

- Water main lowered at Stewart Street Rupanyup, boring to restart this week
- All road rehabilitation jobs nearing completion
- Footpath contract work 50% complete
- School crossing is currently being put in at Hopetoun on Dodgshun Street
- Kerbing to commence in Mcleod Street, Minyip 26/04/2016
- Commence construction of open drain along West side of Stewart Street to next week

**OH&S Officer – Prepared by Bob Taylor**

- Currently actioning traffic management plans for the Anzac Day march in Warracknabeal and Sheep Hills
- Stewart Street and Walter Street Rupanyup Minyip roundabout
- First Aid for southern area 26&27/04
- Working on new outdoor staff induction package
- Finished new chemical books to register all chemical used by Council

**Technical Officer – Prepared by Nathan McLean**

- Organised traffic counter installation and locations, downloaded data and saved report for future works
- Followed up with project managers regarding progress on their Local Government Infrastructure Projects (LGIP)
- Identified and measured up two bus stop sites in Hopetoun and Woomelang to have new concrete and tactile installed
- Communication with Mildura Shade Sails and Gazebos to get a quote to replace shade sail at the Hopetoun recreation reserve over the playground
- Meetings with Mandy Bryce to assist in submitting an application with the Stronger Communities Programme grant for the Ambulance Transfer Station project at the Warracknabeal aerodrome
- Discussions with Joel Turner and James Magee on the project agreement for the Bridges Renewal Programme funding we have received to upgrade the culverts on the Banyena Pimpinio road
- Installed rubber mats at the Lions Park in Warracknabeal to stop softfall being kicked out around playground equipment
- Met with Shane Wardle at Brim to assist with location of Telstra cable for an upcoming project
- Costings on replacement footpath pedestrian crossings with outdoor staff
- Onsite meeting with Graeme Jackson at 71 Main Street, Minyip

**Technical Officer – Tony Brennan**

- Carried out higher duties for Bernie Naylor while on Annual leave until 18 April
- Approved as required Consent Requests for the National Heavy Vehicle Regulator
- Updated vehicle plant list, checklist and report template with vehicle and plant changeovers
- Processed as required Civica requests for road and footpath repairs
- Processed Dial Before You Dig enquiries for any of the above permits that maybe required
- Met with Laser Electrical at Warracknabeal Town Hall to provide quote for upgrading of heating equipment and electrics for auditorium
  
- **Warracknabeal Regional Livestock Exchange**
  
- Obtained quotes for concrete removal and replacement to eliminate trip hazards
- Completed reinstatement of septic tank and realm drain
- Sale held 16 March..... 3,858 head
- Sale held 30 March..... 8,600 head

**Caravan Park Occupancy March 2016**

State	Warracknabeal	Hopetoun	Murtoa
VIC	202	117	211
NSW	20	16	16
WA	21	0	10
QLD	24	6	4
SA	33	0	36
NT	2	0	0
ACT	0	0	2
TAS	2	0	0
International	0	0	4
Permanents	(8 x 3) = 24 (16 x 6) = 96 (7 x 15) = 105	(31 x 0) = 0	(14 x 4) = 56 (17 x 3) = 51
<b>Monthly Occupancy</b>	<b>511</b>	<b>139</b>	<b>390</b>

## **10.8 Community Projects Report – Prepared by Dennis Smith**

### **Country Football and Netball Program 2013/2014 and Putting Locals First Program**

The Hopetoun Community Centre project is progressing well with internal framework, windows, electrical and plumbing rough-in and plastering all completed.

### **Country Football and Netball Program 2014/2015**

Plastering, painting, tiling and floor coverings have all been completed for the Minyip Football and Netball Facilities Upgrade project.

The netball court re-sheeting has been completed with line marking and netball ring height adjustment to be completed early May.

### **Country Football and Netball Program 2015/2016**

An application for funding to construct a new netball/female change room, incorporating showers, toilets and washbasins at Anzac Park has been submitted requesting a grant of \$100,000 for a total project cost of \$153,970.

### **Community Facility Funding Program 2015/2016 – Planning**

The final draft of the new Sport and Recreation Strategy has been advertised for community comment with no submissions received to date. The closing date for comment is 29<sup>th</sup> April.

### **Local Facilities for Local Clubs Program**

The construction of the cricket practice wickets at the Minyip Recreation Reserve is now complete. Appropriate acknowledgement signage has been arranged and put in place. The grant can now be acquitted.

### **Community Sports Infrastructure Fund 2016/2017 – Cricket Facilities**

The application to construct an additional water storage dam to irrigate Anzac Park has not been successful. Alternative funding avenues will now be investigated.

### **Community Sports Infrastructure Fund 2016/2017 – Minor Facilities**

A combined application for improved lighting at the Brim Memorial Bowling Club and new in-ground, fully automated, sprinkler system for the Brim Recreation Reserve has been submitted under this program. The application requests a grant of \$85,200 for a total project cost of \$127,813.

### **Regional Jobs and Infrastructure Fund**

Two projects have been approved under this program.

The first project is the construction of five walking tracks across the Shire with a grant of \$112,200 for a total project cost of \$146,200. The tracks are located in Murtoa; two in Minyip, Woomelang and Yaapeet. Rabl Park (Murtoa) and the two tracks in Minyip are completed. Timing for Woomelang and Yaapeet is yet to be determined.

The second project is streetscape works in Brim and Minyip with a grant of \$130,500 for a total project cost of \$174,000. Meetings with both the Brim Active Community Group and Minyip Progress Association have been held and designs are being finalized.

### **Community Shade Grants Program**

An application (on behalf of the Redda's Park Trustees) for a shade structure over the playground at Redda's Park, Brim, was submitted and has been successful in gaining funding of \$16,300 for a total project cost of \$19,000. The Building Permit has been issued and works are anticipated to commence in May.

### **Transport Investing in Regions Initiative**

A grant of \$15,000 has been received under this program for works at the Patchewollock railway precinct. Work will include construction of a walking track, re-surfacing the car park and installation of interpretive signage.

### **Restoring Community War Memorials and Avenues of Honour Program**

The Anzac Park Memorial Gates restoration project is now complete and acquittal documentation will be prepared after the gates have been re-dedicated on Anzac Day.

### **Other Work Undertaken**

The application submitted under the Better Fishing Fund to install a pontoon at the Brim Weir Pool has been partially successful with funding of approx. \$12,000 offered. Further funding sources will be investigated.

Assisting the Warracknabeal Men's Shed with several grant applications for funding to extend the size of their current premises.

Assisting the Hopetoun Recreation Reserve develop an application to install upgraded lighting for the oval, with a view to submitting the application under the Community Sports Infrastructure Fund 2017/18.

## **11 REPORTS FOR DECISION**

### **11.1 Finance Report – Prepared by Anita McFarlane**

#### **Recommendation**

The Finance Report as at March 2016 be received.

### **11.2 Revenue Report – Prepared by Chantelle Pitt**

#### **Recommendation**

The Revenue Report as at April 2016 be received.



### 11.3 SHARE Community Grants January – April 2016 – Prepared by Marianne Ferguson

Council extensively advertised the SHARE Community Grants Program for a period of 6 weeks throughout the Shire. The total funding available in this round is \$20,000 Inc GST. The evaluation panel consisted of the following representatives: Cr Terry Grange, Cr Andrew Mclean, Cr Graham Massey, Gavin Blinman (Manager Community Services & Development), Dennis Smith (Community Projects Coordinator) and Marianne Ferguson (Community Development Officer).

33 applications were assessed requesting a total of \$68,232.51.

NAME OF ORGANISATION	DESCRIPTION OF REQUEST	FUNDING ALLOCATED
Brim Sports & Social Club Inc	Purchase laptop computer, internet package, software and printer	\$1000.00
Hopetoun Cemetery Trust	Purchase and erect an information board at the entrance to the cemetery	\$1000,00
Hopetoun Gateway Beet Inc On behalf of Hopetoun Traders	Establishment of a Poetry Walk. Design, build erect sandstone plaques. Update and enhance the north and south entrance to town	\$1000,00
Minyip Golf Club Inc	To assist with the purchase and installation of solar panels on the club house	\$2,500.00
Minyip Shocking Arts Collective	Improve community consultation process. Improvement to the workshop space. Purchase materials to exhibit arts	\$200
Murtoa Mechanics Institute and Free Lending Library	Purchase of new stackable auditorium seating	\$1000.00
Murtoa Showyards Reserve	Purchase pavers to make area safe	\$1000.00
Murtoa/Marma Racing Club	Purchase of 300 PVC outdoor chairs	\$1000.00
Rupanyup Major Events	Assist with the running of the Dirt Music Festival To purchase market umbrellas and bases, purchase advertising banners	\$1000.00
Warracknabeal & District Historical Society	Purchase sign for the museum entrance. Purchase solar light to illuminate plough on tower	\$1,700.00
Warracknabeal Rotary Club	To make Australia Day celebrations in 2017 a huge celebratory event (150 years) promotional material, provide cooked breakfast, hire of band and local entertainment, guest speaker	\$2,600.00
Warracknabeal Town Hall Auxiliary	Sponsor a 'welcome newcomers' informative event in the community	\$960.00
Warracknabeal Town Hall Committee of Management	Planning for major upgrade, new kitchen levelling of floor and renovation of upstairs	\$1000.00
Woomelang Lions Club	Containerised Fuel Installation Costs – 24 hour card access	\$3000.00
Yaapeet Community Club Inc	Purchase roller blinds for the community centre	\$1000.00
	<b>Total</b>	<b>\$19,960.00</b>

**Recommendation**

That Council approve the above nominated projects under the 2015/2016 SHARE Community Grant Program.

## **11.4 Town Planning Application Report TP 69-15 Gypsum Extraction Pit – Prepared David Young**

Applicant: Mark Smith  
Application Number: TP 69-15  
Address of application: Clay Road, Lascelles

### **Proposal**

The proposal is to gain a planning permit for the removal of Gypsum from the land. The size of the extraction area is to be approximately 3 hectares in area. (see attachment 1.0 Location Plan)

### **Operation**

The applicant has provided a description of the operation of the Gypsum Pit. The operations include:

- The area to be mined is approximately 3 hectares and is on cleared land used for broadacre farming.
- There is no known flora or fauna that will be affected
- The operation is an extraction process using a scraper and loader to remove the material.
- The Gypsum lies 50 to 100mm of topsoil, predominantly sand. In some areas the resource outcrops with no topsoil present. The gypsum deposit is approximately 300mm thick.
- No blasting is required.
- The recoverable gypsum is calculated as being approximately 9000 cubic meters.
- Operations will be on a yearly basis over a 12 week period each year during months of February, March and April.
- Operating times are proposed to be between the hours of 7:00 am and 6:00 pm, 7 days a week.
- The area will be levelled and ripped prior to crop planting at the end of mining.
- The pit will be no deeper than 400mm, with the rehabilitated pit being 300mm lower than the original level.

### **Subject site & locality**

The subject land is cleared farming land used for broadacre farming. Access to the land is via Reeds Road, a dirt road. There is no known significant flora or fauna within the extraction area. The area immediately adjoining the subject site to the east has been mined previously over a number of years. However, the mining licenses associated with that activity have expired.

Surrounding land consists of broad acre farming with scattered vegetation. The nearest dwelling to the proposed area is some 2 to 2.5 kilometers away from the proposed works. To the west are the Wathe Flora and Fauna Reserve.

### **The zoning of the land, overlay and any relevant provisions**

The subject site on the land is zoned Farm Zone and features no Overlays.

### **Definition**

Gypsum Mining is defined as “Mineral extraction”: Land used for extraction of minerals in accordance with the Mineral Resources (Sustainable Development) Act 1990.

**Permit Triggers**

A planning permit is required under section 52.08 of the Yarriambiack Planning Scheme.

**The State and Local Planning Policy Framework**

The SPPF and LPPF generally support the development of land for Mineral Extraction. The LPPF aims to:

- To facilitate and encourage the exploitation of mineral deposits to enhance the economy of the municipality and region.
- To allow mining, processing and associated research in an environmentally sensitive manner and with regard to the amenity of adjacent land.
- To ensure that all land disturbed by mining operations is appropriately rehabilitated, in a form capable of supporting its previous use.

**Relevant Particular Provisions**

52.08 Earth and Energy Rescore Industry

Purpose:

- To encourage land to be used and developed for exploration and extraction of earth and energy resources in accordance with acceptable environmental standards.
- To ensure that mineral extraction, geothermal energy extraction, greenhouse gas sequestration and petroleum extraction are not prohibited land uses.
- To ensure that planning controls for the use and development of land for the exploration and extraction of earth and energy resources are consistent with other legislation governing these land uses.

52.08-1 Permit Requirement

A permit is required to use and develop land for earth and energy resources industry.

**Advertising**

The application was advertised in accordance with the Planning and Environment Act. The application was advertised as the use and development had the potential to cause detriment to the surrounding areas through noise, dust and traffic movement.

**Objection**

One submission has been received.

The submission is based on:

- Failure to rehabilitate the land
- Damage to road network
- Failure to compensate the land owner  
(See attachment 2.0 Objection letter)

**State and Local Government Legislation and Requirements**

A recently introduced changes to the Mineral Resources (Sustainable Development) Act 1990 (MRSD Act) changed how an application to extract minerals from small areas of land are to be considered and approved.

Under the MRSD Act small operators can elect to use the “code of practice” instead of obtaining a work plan. Operators are required at all times to comply with the Code. The following is a summary of the purpose and intent of the Code.

*In Victoria, mineral exploration and mining activities are regulated under the Mineral Resources (Sustainable Development) Act 1990 (MRSD Act). The purpose of the MRSD Act is to encourage an economically viable mining industry that makes the best use of mineral*

*resources in a way that is compatible with the economic, social and environmental objectives of the state.*

*The MRSD Act provides for the creation of codes of practice to provide practical guidance on complying with legislative obligations. An amendment to the MRSD Act in 2014 allowed holders of prospecting or mining licences, where engaged in mining activities defined as low risk, to comply with a binding Code of Practice rather than submit a work plan.*

*Mining projects seeking to operate under the Code must have a licence area of 5 hectares or less, and must not involve underground operations, blasting, clearing of native vegetation or the use of chemical treatments.*

*The Code has been developed in accordance with the requirements of Section 89A of the MRSD Act. It has been developed on the expectation that well-planned and managed mining projects should have little or no lasting impact on the environment and impose minimal disruption to other land users and the community.*

*Prior to carrying out any mining activities on land, miners are required to hold a prospecting or a mining licence and to have been granted permission to commence mining activities by DEDJTR. The MRSD Regulations prescribe various procedures, details, royalties, fees, forms, information required in documents and other matters authorised by the MRSD Act.*

*The Code encourages licensees to adopt an active and committed approach to compliance, and promotes mining practices that prevent or minimise impacts on the environment, infrastructure, community and other land users.*

Under the Planning and Environment Act and Planning Schemes a planning permit is still required to be obtained and assessed by Council.

### **Assessment**

The general thrust behind both the State and Local Planning Policy Framework is to encourage the extraction of minerals in a sustainable manner that enhances the economy of the municipality and region. Extractive industries do this on a number of fronts. Firstly, the employment associated directly with the removal of the resource. Secondly the employment associated with the use of the resource. Thirdly the return of the land back to farming at the completion of the extraction.

The land and the immediate surrounding area can best be described as cleared, relatively flat farming land. There is no known significant Flora or Fauna associated with the site. No vegetation will be removed as part of the process.

The proposed development will not have a lasting impact on the landscape. Once completed and rehabilitated, the ground level in the areas of extraction will be lower than that of the surrounds and mostly unnoticeable.

Due to the location of the proposed extractive industry and the sparse nature of dwellings in the area, the effects of vehicle movement on residents of dwellings will be somewhat limited. Truck movement will be between daylight hours and restricted to hours specified.

The applicant will need to ensure that dust suppression methods will be used on site and (if needed) on any gravel roads to ensure dust is kept to a minimum.

**Objectors concerns**

The objection to the application was on a number of matters.

The rehabilitation of the land is governed through the MRSD Act and a bond is usually paid, prior to works commencing, which would ensure that when completed the land is returned to normal use or an agreed use. The bond is administered by Earth Resources Regulations.

Failure to compensate the land owner is a matter between parties and not Council. It is not a requirement under any legislation that Council has any ability to influence.

Impact on the road network is a matter directly linked to Council and the consideration of a planning permit. Councils Engineering Unit have investigated the application and believe the road is required to be upgraded to a suitable standard to maintain a safe and usable public road in accordance with Council requirements. Councils Engineering Unit has requested a condition be placed on the permit to require the upgrade of Reeds Road to bring it to a standard as specified under Councils Road Hierarchy Policy. The required conditions are:

- Limestone gravel road to be constructed on Reeds Rd from Sunraysia Highway to property line at entrance gate.
- Gravel to be a minimum compacted thickness of 200mm with minimum width of 4m.
- Gravel to be compacted to minimum 96% characteristic density ratio.
- Gravel shall be extended 20m north and south of Reeds Rd onto Gama South Rd so as to make a smooth transition.

**Applicants response to objection**

The following is a response to the objection received by Council from the applicant.

*The landowner did not object to the Prospecting License or the process of pegging the deposit, which was granted December 2013. This gives the legal right to the minerals to Mr Smith. For Mr Smith to extract the minerals he is required to obtain a planning permit under the new legislation in-acted recently.*

*For nearly 20 years the owners of the land Mr G Symes parents, Mr Ken & Lois Symes were compensated for the loss of income and inconvenience of the mine as per granting of the licence 4602. The land formally changed ownership recently to their son Mr G Symes.*

*The mine was inspected by the mines inspector at least twice per year and License Holder Mr Smith, met all the requirements as per the approved rehabilitation plan.*

*Compensation was paid to the owners of the Land Mr Ken and Lois Symes as per the compensation agreement. Mr Graeme Symes was not the owner of the land or part of the compensation agreement relating to min 4602.*

*Reeds Road is in good condition although the shire has received some complaints in previous years after an estimated 3000 tonnes of gypsum annually travelling on the road.*

*Local farmers, including Mr Graeme Symes have used the gypsum annually. In fact Mr G Symes has had free issued gypsum for a number of years, given in good faith from the Smiths.*

*Under recently in-acted legislation Mr Smith now requires a planning permit from the shire as per the Prospecting Licence (PL) 1014 requirements. This PL has been granted to for a once off term of 5 Years.*

*Historically the Smith family have been mining gypsum for 40 years and have always operated within the guidelines of the Minerals and Energy Department.*

*Mr G Symes was informed formally and informally of PL1014 and the associated planning permit application as part of the process required to start mining. The Smiths refute Mr Symes claims and continue to demonstrate their commitment to their obligations, this being supported by the Earth Resources and Regulation, part of the Department of Economic Development, Jobs, Tourism and Resources, through the granting of PL1014. This occurred after changes in legislation meant changing tenure from an old mining license MIN4602. Mr*

*Smith continues to engage with Mr G Symes to no avail, with numerous attempts at correspondence to engage, but never triggering a response.*

*It is our belief that Mr G Symes would like to hold up this permit and Mr Smiths extraction operation to see the PL expire thus enabling access to the gypsum for his own benefit excluding the Smiths which have mined the area for 20 years.*

Applicant's response to Engineering proposed road condition:

*I would like to remind you that there will only be a maximum of 3000 tonne per year carted from the mine. This equates to 1 truck load per day for 90 days per year.*

*There is only an estimated 7000 tonne of gypsum remaining to be mined. This equates to 210 truck loads in total left to be carted. This equates to 1 truck load per day for 210 days.*

*I use 1 truck to cart from the mine. The only truck that would be carting from the mine is my own. No other trucks are permitted on my mine site.*

*The usage of Reeds Rd for the purpose of my permit would be limited to 1 truck of which is my own. This is what I have done in the past and intend to do so in the future. This should be one of the conditions of the permit that guarantees road user safety and road integrity.*

*I will only use the road in dry weather. I could implement a speed restriction on myself to help guarantee safety.*

*I suggest the road being graded if the road were to deteriorate as being a more reasonable solution to asset protection.*

*I still do not know how council assesses what standard of road is needed?*

*I know from history that Reeds Rd is capable of handling the traffic/freight safely. I have used Reeds Rd for the purpose of the same gypsum mine since 1978 and there have been no accidents and the road has remained in good condition with minimal maintenance. I have carted an estimated 500,000 tonne of gypsum on that road since 1978. What has changed?*

*Please don't hesitate to contact me with questions you may have. I would like to be consulted in order to come to a solution that is reasonable to all stakeholders.*

## **Conclusion**

Based on the assessment of the application and consideration of the objection to the application it is recommended that Council support the application subject to the recommended conditions.

A number of concerns raised by the objector are not matters Council can have influence over or deal with under the Act. The other matters are considered covered by the proposed conditions.

## **Recommendation**

That Council having caused notice of Planning Application No.TP 69-15 to be given under Section 52 of the *Planning and Environment Act 1987* and having considered all the matters required decides to Grant a Notice of Decision to Grant a Permit in respect of the land known and described as Crown Allotment 37A, Parish of Gamma for the use and development of the land for Mineral Extraction in accordance with the endorsed plans and subject to the following conditions:

**Conditions**

1. The layout of the uses on the endorsed plan must not be altered without the written consent of the responsible authority.
2. The development use of the subject land must not commence until:
  - The any and all approvals are granted in accordance with the requirements of the Mineral Resources (Sustainable Development) Act 1990 (MRSDA).
  - All road and access upgrades are completed and inspected by the responsible authority.
3. The use must be managed so that the amenity of the area is not detrimentally affected, through the:
  - transport of materials, goods or commodities to or from the land
  - appearance of any building, works or materials
  - emission of noise, artificial light, vibration, smell, fumes, smoke, vapour, steam, soot, ash, dust, waste water, waste products, grit or oil
  - Presence of vermin.
4. The hours of operation for any activity on the site are 7 am to 6 pm seven days per week.
5. No vegetation is to be removed for the use to occur, including access ways, trafficable areas and extraction areas, without the further consent of the responsible authority.
6. Noise levels emanating from the land must comply with the requirements of the Environment Protection Authority's Information Bulletin No. N3/89 Interim Guidelines for the Control of Noise in Country Victoria.
7. All roads/storage areas/external stockpiles/vacant or grazed areas must be maintained to avoid dust nuisance to the satisfaction of the responsible authority.
8. No polluted and/or sediment laden run-off is to be discharged directly or indirectly into Councils drains or watercourses. To this end, pollution or litter traps must be provided on site.
9. All works must be undertaken in a manner that minimises soil erosion, and any exposed areas of soil must be stabilised to prevent soil erosion, to the satisfaction of the responsible authority.
10. No environmental weeds may be planted on or allowed to invade the site.
11. Access to the site shall only be at the nominated crossing shown on the endorsed plan. The crossing and road pavement works are to be constructed to the satisfaction of the responsible authority.
12. The applicant/owner is to carry out the following road works prior to the use commencing:
  - Limestone gravel road to be constructed on Reeds Rd from Sunraysia Highway to property line at entrance gate.
  - Gravel to be a minimum compacted thickness of 200mm with minimum width of 4m.
  - Gravel to be compacted to minimum 96% characteristic density ratio.
  - Gravel shall be extended 20m north and south of Reeds Rd onto Gama South Rd so as to make a smooth transition.
  - The access to the property is to be constructed to the standard as specified by the responsible authority in accordance with Councils IDM manual requirements.
13. The loading and unloading of goods from vehicles must only be carried out on the land at all times.
14. The use of the subject land must at all times be in accordance with the Code of Practice for Low Risk Mines as made under section 89E of the Mineral Resources (Sustainable Development) Act 1990(the Act)
15. This permit will expire if one of the following circumstances applies:
  - The use and development is not started within two years of the date of this permit. The responsible authority may extend the periods referred to if a request is made in writing before the permit expires, or within six months afterwards.



Attachment 1.0

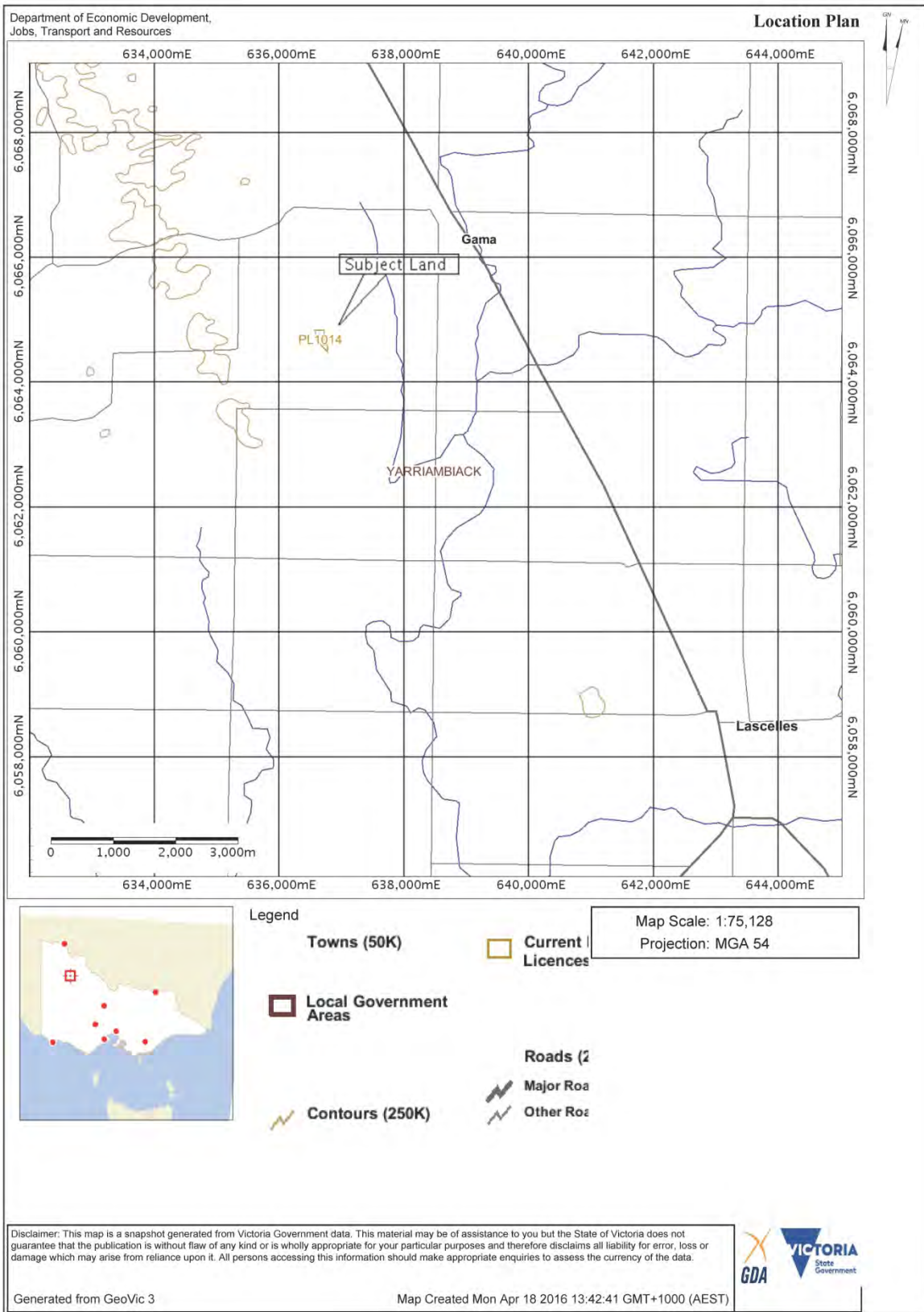

Attachment 2.0

CENTRAL FILE *21/10/15* *21/10/15*  
 No. P 30/15

Symco 2 Pty Ltd,  
 GK & KL Symes Super Pty Ltd  
 Box 13  
 Lascelles  
 11.11.2015

Dear Sir/ Madam,

**COPY**

Re Planning Permit Application No. TP69-15

I am writing to you to object to the granting of Planning Permit Application No. TP69-15 for Reed's Road, Lascelles being CA..37 Parish of Gama.

As the owner of this land, I have a number of grounds for objection to this permit. The applicant Mr Mark Smith, has mined gypsum from our property for an extended time and during this time he has continually failed to satisfactorily rehabilitate the area from which the gypsum has been extracted. Not only has he failed to meet our requirements but the relevant Government Departments despite repeated request to do so. After the said area has been mined it has a much reduced productivity potential leading to future economic losses from our normal farming operation.

The applicant has also negligent in promptly paying compensation for disruption to our farming operation for a number of years.

The applicant, Mr Smith, has to use poor quality earthen roads to cart this gypsum from our property. These roads are a shire responsibility and it is my belief that said operation lead to significant damage to Reeds Rd in particular which created further access problems to areas of our property, not only while the mining operation is in progress but also for long afterwards. This damage is in the form of pot holes developing in the sandy road and general erosion of the quality of the roads as compared to carting heavy loads over a properly constructed and gravelled roads.

I hope that you will take these objection's into consideration when you determine whether to grant Planning Permit No TP 69-15.

I would also like to remind you that the affected land is within Yarriambiack Shire Council boundaries and is of little ,if any, economic benefit to your rate payers but instead will be transferred outside Shire boundaries

Your faithfully



G.K. Symes

RECEIVED  
 13 NOV 2015  
 Yarriambiack Shire Council

**11.5 Town Planning Application Report TP 07-16 – Prepared by David Young**

Applicant Willem Polman:

Address of application: 68 Phillips Street Beulah

Application Number: TP 07-16

**Proposal**

The proposal is to establish a licenced liquor area (red line area) within the existing Supermarket to sell packaged alcohol to the public at 68 Phillip Street, Beulah. (See attachment 1.0 Application)

**Subject site & locality**

- The subject land contains an existing IGA Supermarket and News Agency. The red line area of the proposed bottle shop will be at the rear of the Supermarket. All services and access exist to the site.
- The Supermarket is located centrally to the Township and adjoins other commercial premises.
- The surrounding land use consists of a mixture of residential and commercial development.

(See attachment 2.0 Location plan.)

**The zoning of the land, overlay and any relevant provisions**

The subject land is zoned Township and features no Overlays.

**Permit Triggers**

A planning permit is required under section 52.27 of the Yarriambiack Planning Scheme. 52.27 Permit required. "A permit is required to use land to sell or consume liquor if any of the following apply: A licence is required under the Liquor Control Reform Act 1998."

**The State and Local Planning Policy Framework**

The SPPF and LPPF generally support the continued development of business and services to small communities to assist with retention of business and population within these areas.

**Relevant Particular Provisions**

52.27 Licensed Premises

Purpose:

- To ensure that licensed premises are situated in appropriate locations.
- To ensure that the impact of the licensed premises on the amenity of the surrounding area is considered.

Before deciding on an application, in addition to the decision guidelines in Clause 65, the responsible authority must consider, as appropriate:

- The State Planning Policy Framework and the Local Planning Policy Framework, including the Municipal Strategic Statement and local planning policies.
- The impact of the sale or consumption of liquor permitted by the liquor licence on the amenity of the surrounding area.
- The impact of the hours of operation on the amenity of the surrounding area.
- The impact of the number of patrons on the amenity of the surrounding area.
- The cumulative impact of any existing licensed premises and the proposed licensed premises on the amenity of the surrounding area.

**Advertising**

The application was advertised in accordance with the Planning and Environment Act. The application was advertised as liquor licences may cause detriment through the supply of additional alcohol to the surrounding areas and township.

**Objections**

Three submissions have been received.

The submissions are based on:

- the need to maintain a commercial advantage for the Hotel and Café in the Township;
- what a new liquor license may do to their business;
- Community impacts on the town if the Hotel closes.

(See attachment 3.0 Objection letters)

**Assessment**

The proposal is to establish a red line area, within the building, for the sale on packaged liquor for consumption off the premises. This is to be done in conjunction with the existing supermarket operating from the site. The proposal is generally in keeping with modern thinking in allowing supermarkets to sell package alcohol as part of a regular consumable line.

The State Planning Policy Framework and the Local Planning Policy Framework, including the Municipal Strategic Statement and local planning policies generally support the development and improvement of services and facilities to the service the township and surrounding areas.

It is not expected, the approval of a liquor license, will impact on the amenity of the surrounding area. The liquor will be removed from the premises and consumed elsewhere, usually at home. There is no allowance for consuming the alcohol on the premises or streets and this in itself will limit any potential amenity issues.

There is one other licensed premises in close proximity, the Beulah Hotel, and the cumulative impact from allowing another premises to sell alcohol will have little impact on the amenity of the surrounding area. The hotel operates at different times to the supermarket and caters for different clientele, one drinking on a premises and one off the premises and different hours of operation.

The majority of the submissions raised objections based on commercial matters. The objections to the application are considered to be trying to maintain a direct and indirect commercial advantage by stopping other business from competing in the market and not lodging objections on planning grounds. Based on this Council should rejected the objections to the application that deal with trying to maintain a commercial advantage.

Yarriambiack Shire Council is guided by the Planning and Environment Act 1987 and Planning Scheme when considering planning applications and submissions from the general public.

The Planning and Environment Act 1987 - SECT 57 states: "Objections to applications for permits. (2A) The responsible authority may reject an objection which it considers has been made primarily to secure or maintain a direct or indirect commercial advantage for the objector."

Under the Planning and Environment Act 1987 - SECT 57 (2B), if an objection has been rejected under subsection (2A) this Act applies as if the objection had not been made,"

The other matters raised in the objection letters deals with community impacts that may occur if other businesses close, especially the Hotel, as a result of allowing the permit to be issued. The matters raised in the objection letters are issues that Council needs to consider in a wider picture but are not relevant when making a decision on this application. However, Council should issue a "Notice of Decision" to enable the objectors to take the matter further if they wish to do so.

### **Conclusion**

Based on the above assessment it is not expected that the granting of a license to allow the sale of packaged alcohol will have any form of impact on the amenity of the area. The objections to the application are considered to be trying to maintain a direct and indirect commercial advantage by stopping other business from competing in the market.

### **Recommendation**

That Council having caused notice of Planning Application No.TP 07-16 to be given under Section 52 of the *Planning and Environment Act 1987* and having considered all the matters required decides to Grant a Notice of Decision to Grant a Permit in respect of the land known and described as 68 Phillips Street, Beulah for the use of the land for a liquor license in accordance with the endorsed plans and subject to the following conditions:

### **Conditions**

1. The endorsed plans must not be altered without the written consent of the responsible authority.
2. The area of the Licence must be totally within the confines of the area marked red on the endorsed plans.
3. At all times during the operation of the use, there must be present on the premises a person over the age 18 years who is responsible for ensuring that the activities on the premises and the conduct of persons attending the premises do not have a detrimental impact on the amenity of the locality to the satisfaction of the responsible authority.
4. The sale of packaged alcohol is limited to the same hours of operation of the supermarket and must be run in conjunction with the supermarket at all times.
5. This permit will expire if one of the following circumstances applies:
  - i. The use is not started within two years of the date of this permit.

The responsible authority may extend the periods referred to if a request is made in writing before the permit expires, or within six months afterwards.

Attachment 1.0

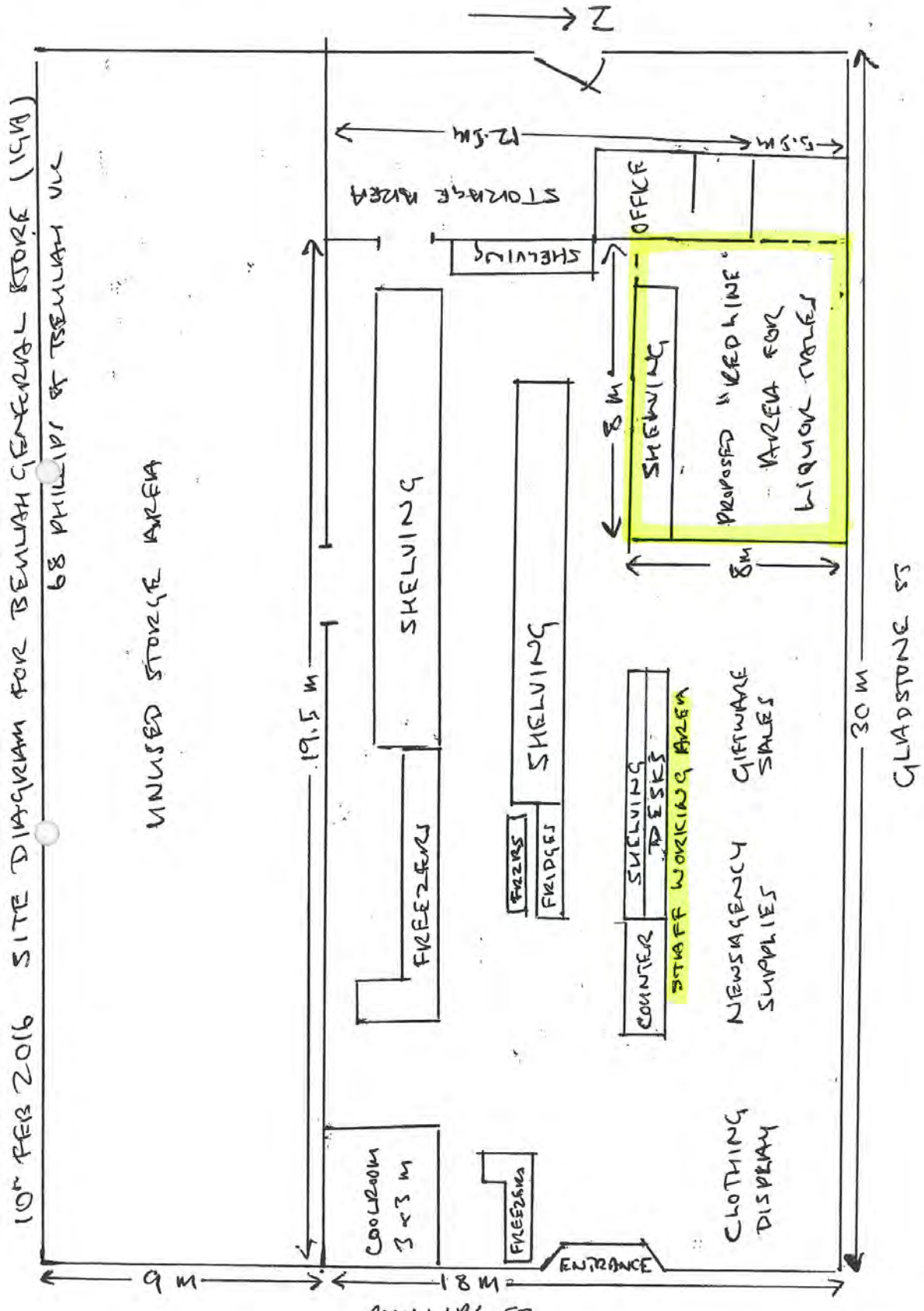



## Attachment 2.0

8 March 2016

Ms Kathy Edwards  
Planning Administration Officer  
Yarriambiack Shire Council  
34 Lyle St  
Warracknabeal 3393

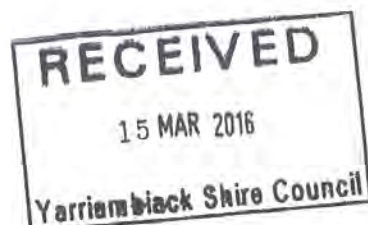

Dear Ms Edwards

As long time residents of Beulah we wish to object to the application for Mr W. Polman Beulah General Store for a liquor licence.

The Morris family have run the hotel for over twenty five years and have served the community extremely well.

Because of the population decline over the years and the fact that the prices charged at Bill Polman's store, a lot of people are now shopping out of town thus it is affecting all the business traders of the town.

The hotel supplies the Meals On Wheels program and a luncheon on Fridays for the elderly people along with counter meals through the week and it is the only place in town that caters for meals, drinks and a place where people can socialise on a Saturday evening.

We believe any opposition to the hotel could be the last nail in the future of the hotel's survival and the town's future.

Therefore we object to any opposition to the above mentioned licence because the population of Beulah does not warrant a second liquor licence outlet.

Yours Sincerely,

Ted and Von Lehmann.

**11.6 Speed Limit on Henty Highway at Brim – Prepared by James Magee**

For the majority of this year, since the mural has been painted on the Brim silos, a temporary speed limit has been in place on the Henty Highway adjacent the silos. The limit was put in place by Vicroads after a request was made by Vic Police which was supported by Council. The intention was to create a safer environment for those wishing to view the silo artwork. While several months have passed, the silos are still generating many viewers and the Brim Active Community Group have requested that the speed limits are made permanent. The group have also quizzed others in the community and all have been in favour.

I support the request and believe Council should apply to Vicroads to have the speed limit permanently lowered.

**Recommendation**

That Council request Vicroads to implement a permanent 60km/hr speed zone for Brim and to provide advice on the type of advance warning signage that may be beneficial as well as parking signage adjacent the site.



**12 GENERAL BUSINESS** (including strategic direction and specific issues)

**13 CLOSED SESSION**

**14 MINUTES FROM MEETINGS**

**15 ATTACHMENTS / REPORTS**

Planning Permit Activity Report for March 2016  
Rates Report – April 2016  
Income Statement by Resources for March 2016  
Income Statement by Department for March 2016  
Capital Expenditure for March 2016  
Balance Sheet as at 31 March 2016

**16 NEXT MEETING**

The next meeting of Council will be held on Wednesday, 25 May 2016 at 9:30am at Warracknabeal.

**17 CLOSE**

\_\_\_\_\_  
**Mayor**

Application Identifier	Application type	Property Location					Estimated Cost of Works	Proposed Use or Development	Applicant Details				Date Application Received	Responsible Authority Outcome	Date of Responsible Authority Outcome
		Street Address		Crown Description		Lot on Plan			Name	Street Number, Name, Type					
		Street Number, Name, Type	Locality	Allotment, Parish/Township	Lot	Plan				Street Number, Name, Type	Locality	State			
TP69-15	New application	Reeds Rd	Lascelles	CA37 Parish Gama			\$25,000	Use and Development of Land for mineral extartction (Gypsum Extraction)	Mark Smith	32 Campbell St	Birchip	Vic	27/10/2015	In progress	
TP72-15	New application	Patchewollock Sea Lake Road	Patchewollock	CA19A	Lot 1	TP374377X	\$350,000	Use and Development for a Rural Store	Wade Humphreys	PO Box 40	Nullawil	Vic	23/10/2015	Lapsed	15/03/2016
TP03-16	New application	3 Albrechts Rd	Murra Warra	CA89, Parish of Kewell West			\$200,000	Construction of Telecommunications Facility	Visionstream	Locked Bag 4001	Heatherton	Vic	27/01/2016	Permit issued by a delegate of the Responsible Authority	03/03/2016
TP04-16	New application	9 Boolite-Donald Rd,	Boolite	CA24a, Parish of Dunmunkle			\$250,000	Construction of Telecommunications Facility	Exomm Intergrated Services	Shop 3, 157 Martin St	Brighton	Vic	02/03/2016	In progress	
TP05-16	New application	13 Marma St	Murtoa		Lot 2	LP134765	\$24,000	Construction of a Garage	Robin Barber	PO Box 669	Horsham	Vic	09/02/2016	Permit issued by a delegate of the Responsible Authority	15/03/2016
TP07-16	New application	68 Phillips St	Beulah	CA4 Sec 9 Parish Galaquil			\$5,000	Sale of Package Liquor	Willem Polman	24 Hent Highway	Beulah	Vic	15/02/2016	In progress	

# YARRIAMBIACK SHIRE COUNCIL

## INCOME STATEMENT BY RESOURCES FOR MARCH 2016

	2014/2015 Budget	2014/2015 Actuals	March Actuals	2015/2016 Budget	YTD Actuals	Forecast	YTD Variance	YTD % Variance
<b>Income</b>								
Asset Disposal & Fair Value Adjustments	\$ (400,000)	\$ (375,190)	(110,270)	(297,800)	(286,701)	(312,800)	(11,099)	4%
Contributions, Donations & Reimbursement	\$ (309,839)	\$ (264,320)	(9,770)	(235,911)	(147,170)	(230,461)	(88,741)	38%
Government Grants & Charges	\$ (9,225,566)	\$ (11,155,366)	(273,684)	(8,870,887)	(6,408,668)	(7,432,084)	(2,462,219)	28%
Interest Income	\$ (139,921)	\$ (138,836)	(51,396)	(107,021)	(67,309)	(77,021)	(39,712)	37%
Rates & Charges	\$ (10,594,460)	\$ (10,827,963)	766,023	(11,314,254)	(11,324,189)	(11,323,417)	9,935	(0%)
Sale Proceeds - Contra Sales	\$ -	\$ -	0	0	(173)	(173)	173	0%
User Charges, Fees & Fines	\$ (1,051,752)	\$ (1,163,322)	(69,284)	(1,028,072)	(705,167)	(1,115,849)	(322,905)	31%
<b>Income Total</b>	<b>\$ (21,721,538)</b>	<b>\$ (23,924,996)</b>	<b>251,620</b>	<b>(21,853,945)</b>	<b>(18,939,377)</b>	<b>(20,491,805)</b>	<b>(2,914,568)</b>	<b>13%</b>
<b>Expenditure</b>								
Asset Disposal & Fair Value Adjustments	\$ 300,412	\$ 944,791	0	309,424	0	309,424	309,424	100%
Bad & Doubtful Debts	\$ -	\$ 36,998	0	0	0	0	0	0%
Contributions & Donations	\$ 892,342	\$ 851,753	41,268	977,245	735,506	809,261	241,739	25%
Depreciation Amortisation & Impairment	\$ 6,251,313	\$ 6,568,314	0	6,438,426	0	6,438,426	6,438,426	100%
Employee Costs	\$ 7,637,865	\$ 7,403,109	512,887	7,770,428	5,551,272	7,263,720	2,219,156	29%
Finance Costs	\$ 72,866	\$ 108,979	3,469	123,396	50,139	68,396	73,257	59%
Materials	\$ 5,215,260	\$ 4,955,062	397,422	4,633,460	3,584,201	4,725,857	1,049,259	23%
Other Expenses	\$ 1,357,868	\$ 1,333,339	68,994	1,299,629	1,051,918	1,342,183	247,711	19%
<b>Expenditure Total</b>	<b>\$ 21,727,926</b>	<b>\$ 22,202,345</b>	<b>1,024,039</b>	<b>21,552,008</b>	<b>10,973,037</b>	<b>20,957,267</b>	<b>10,578,971</b>	<b>49%</b>
<b>Total</b>	<b>\$ 6,388</b>	<b>\$ (1,722,651)</b>	<b>1,275,659</b>	<b>(301,937)</b>	<b>(7,966,340)</b>	<b>465,462</b>	<b>(1,577,596)</b>	

# YARRIAMBIACK SHIRE COUNCIL

## INCOME STATEMENT BY DEPARTMENT FOR MARCH 2016

	2014/2015 Budget	2014/2015 Actuals	March Actuals	2015/2016 Budget	YTD Actuals	Forecast	YTD Variance	YTD % Variance
<b>Income</b>								
Community Services	\$ (1,974,579)	\$ (2,215,881)	(197,799)	(1,863,121)	(1,602,666)	(2,126,449)	(260,455)	14%
Corporate Services	\$ (14,552,348)	\$ (17,406,375)	708,750	(15,348,378)	(12,256,034)	(12,562,198)	(3,092,344)	20%
Economic Development	\$ (988,531)	\$ (1,047,968)	(123,975)	(268,264)	(395,724)	(497,651)	127,460	(48%)
Engineering	\$ (2,725,221)	\$ (1,476,163)	(114,399)	(2,749,800)	(3,136,634)	(3,406,221)	386,834	(14%)
Recreation & Culture & Leisure	\$ (264,361)	\$ (486,460)	(5,819)	(360,970)	(312,919)	(570,913)	(48,051)	13%
Regulatory Services	\$ (157,739)	\$ (160,509)	(10,383)	(147,663)	(157,021)	(201,845)	9,358	(6%)
Waste & Environment	\$ (1,058,759)	\$ (1,131,638)	(4,756)	(1,115,749)	(1,078,379)	(1,126,528)	(37,370)	3%
<b>Income Total</b>	<b>\$ (21,721,538)</b>	<b>\$ (23,924,996)</b>	<b>251,620</b>	<b>(21,853,945)</b>	<b>(18,939,377)</b>	<b>(20,491,805)</b>	<b>(2,914,568)</b>	<b>13%</b>
<b>Expenditure</b>								
Community Services	\$ 2,750,681	\$ 2,653,577	243,055	2,784,790	1,959,254	2,892,241	825,536	30%
Corporate Services	\$ 1,928,109	\$ 1,652,233	117,340	1,971,414	1,198,525	1,750,237	772,889	39%
Economic Development	\$ 1,020,560	\$ 1,248,749	45,717	772,285	560,384	823,823	211,901	27%
Engineering	\$ 11,069,421	\$ 11,838,719	287,042	10,954,703	3,642,013	10,551,436	7,312,690	67%
Governance	\$ 1,012,911	\$ 865,027	43,105	1,080,027	742,240	917,406	337,787	31%
Recreation & Culture & Leisure	\$ 1,377,604	\$ 1,292,057	90,407	1,344,019	901,548	1,409,671	442,471	33%
Regulatory Services	\$ 663,416	\$ 663,719	37,661	662,004	450,863	610,140	211,141	32%
Waste & Environment	\$ 1,905,224	\$ 1,988,264	159,712	1,982,766	1,518,210	2,002,313	464,556	23%
<b>Expenditure Total</b>	<b>\$ 21,727,926</b>	<b>\$ 22,202,345</b>	<b>1,024,039</b>	<b>21,552,008</b>	<b>10,973,037</b>	<b>20,957,267</b>	<b>10,578,971</b>	<b>49%</b>
<b>Total</b>	<b>\$ 6,388</b>	<b>\$ (1,722,651)</b>	<b>1,275,659</b>	<b>(301,937)</b>	<b>(7,966,340)</b>	<b>465,462</b>	<b>(1,577,596)</b>	

**YARRIAMBIACK SHIRE COUNCIL  
CAPITAL EXPENDITURE FOR MARCH 2016**

	2014/2015 Budget	2014/2015 Actuals	March Actuals	2015/2016 Budget	YTD Actuals	Forecast	YTD Variance	
<b>01929 - Administration - Capital</b>								
0900 - Building Capital Works	\$ 5,000	\$ 17,910	0	30,000	28,021	28,020	1,979	7%
0910 - Furniture & Equipment Capital Works	\$ 2,000	\$ -	0	2,060	0	0	2,060	100%
<b>01939 - Asset Management - Capital</b>								
0920 - Computer / IT Capital Works	\$ -	\$ 6,528	0	39,500	37,065	39,500	2,435	6%
<b>01949 - Information Technology - Capital</b>								
0920 - Computer / IT Capital Works	\$ 20,000	\$ 6,258	1,636	20,000	1,636	20,000	18,364	92%
<b>02919 - HACC Administration - Capital</b>								
0910 - Furniture & Equipment Capital Works	\$ -	\$ 2,800	0	0	3,436	3,436	(3,436)	0%
0920 - Computer / IT Capital Works	\$ -	\$ -	0	0	0	0	0	0%
<b>02929 - MECC - Capital</b>								
0910 - Furniture & Equipment Capital Works	\$ 2,228	\$ -	0	2,000	0	15,000	2,000	100%
<b>02939 - Senior Citizens - Capital</b>								
0900 - Building Capital Works	\$ 80,000	\$ 288	0	95,000	63,066	101,500	31,934	34%
<b>02949 - Environmental Health - Capital</b>								
0910 - Furniture & Equipment Capital Works			0	0	4,043	5,500	(4,043)	0%
<b>02959 - Animal Pound - Capital</b>								
0930 - Animal Pound - Capital Works	\$ -	\$ -	0	0	14	0	(14)	0%
<b>02969 - Maternal &amp; Child Health - Capital</b>								
0900 - Building Capital Works	\$ 20,000	\$ 70,732	1,039	6,556	5,540	11,058	1,016	15%
0920 - Computer / IT Capital Works	\$ 2,500	\$ -	0	6,500	0	0	6,500	100%
<b>02979 - Fire Hydrants - Capital</b>								
0965 - Fire Hydrants - Capital	\$ -	\$ -	0	4,000	0	0	4,000	100%
<b>02989 - Preschools - Capital</b>								
0900 - Building Capital Works	\$ 43,000	\$ 487	0	5,000	7,120	7,120	(2,120)	(42%)
<b>03909 - Industrial Estate - Capital</b>								
0905 - Industrial Estate Capital Works	\$ 35,000	\$ -	674	15,000	11,045	13,000	3,955	26%
<b>03919 - Caravan Parks - Capital</b>								
0900 - Building Capital Works	\$ 76,000	\$ 57,525	2,000	10,000	34,562	35,000	(24,562)	(246%)
0910 - Furniture & Equipment Capital Works	\$ 2,000	\$ -	0	2,000	0	2,000	2,000	100%
<b>03929 - Public Amenities - Capital</b>								
0900 - Building Capital Works	\$ 5,000	\$ -	6,062	70,000	65,146	65,000	4,854	7%
<b>04939 - Hall - Capital</b>								
0900 - Building Capital Works	\$ 48,000	\$ 48,459	0	50,000	2,588	2,588	47,412	95%
<b>05909 - Parks &amp; Playgrounds - Capital</b>								
0975 - Playground Capital Works	\$ 21,630	\$ 105,386	0	10,000	137,409	137,408	(127,409)	(1274%)
<b>05919 - Recreation Reserve - Capital</b>								
0900 - Building Capital Works	\$ -	\$ -	60,000	348,000	180,636	360,000	167,364	48%
<b>05939 - Swimming Pool - Capital</b>								
0900 - Building Capital Works	\$ 20,000	\$ -	0	20,000	0	10,000	20,000	100%
<b>05949 - Sporting Complex - Capital</b>								
0900 - Building Capital Works	\$ 5,000	\$ 37,330	0	5,000	0	5,000	5,000	100%
0910 - Furniture & Equipment Capital Works	\$ 4,000	\$ -	0	4,000	0	4,000	4,000	100%
<b>05959 - Gymnasium - Capital</b>								
0910 - Furniture & Equipment Capital Works	\$ 4,000	\$ -	0	0	0	0	0	0%
<b>06909 - Local Roads - Capital</b>								
0935 - Urban Road Construction	\$ 186,000	\$ 255,868	10,129	191,120	133,115	159,120	58,005	30%
0940 - Rural Road Construction	\$ 2,363,544	\$ 2,605,985	239,022	2,325,481	1,795,523	2,225,481	529,958	23%
0945 - Reseals	\$ 229,911	\$ 231,432	0	336,912	133,241	336,912	203,671	60%
0950 - Resheets	\$ 1,178,760	\$ 1,465,280	21,816	1,135,608	979,881	1,355,608	155,727	14%
0955 - Shoulder Resheets	\$ 378,721	\$ 489,651	94,486	376,840	660,241	676,840	(283,401)	(75%)
<b>06919 - Footpath - Capital</b>								
0980 - Footpath Construction	\$ 201,337	\$ 136,014	28,210	211,992	52,610	211,592	159,382	75%
<b>06929 - Bridge - Capital</b>								
0990 - Bridge Construction	\$ 32,726	\$ -	0	33,764	0	0	33,764	100%
<b>06939 - Kerb &amp; Channel - Capital</b>								
0985 - Kerb & Channel Construction	\$ 300,000	\$ 278,972	24,080	311,410	298,566	341,090	12,844	4%
<b>06959 - Aerodrome - Capital</b>								
0900 - Building Capital Works	\$ -	\$ 22,542	0	0	97,344	0	(97,344)	0%
0950 - Resheets	\$ 150,000	\$ 37,980	15,220	530,458	21,470	530,458	508,988	96%
<b>06979 - Depot - Capital</b>								
0900 - Building Capital Works	\$ 250,000	\$ 275,601	6,797	108,000	319,777	300,000	(211,777)	(196%)
<b>07909 - Drainage - Capital</b>								
0995 - Drainage Construction	\$ 33,297	\$ 50,478	0	35,000	0	20,000	35,000	100%
<b>07929 - Transfer Stations &amp; Landfills - Capital</b>								
0960 - Waste Site Capital Works	\$ 20,000	\$ 6,285	0	20,000	8,001	20,000	11,999	60%

**YARRIAMBIAK SHIRE COUNCIL  
CAPITAL EXPENDITURE FOR MARCH 2016**

	2014/2015 Budget	2014/2015 Actuals	March Actuals	2015/2016 Budget	YTD Actuals	Forecast	YTD Variance	
<b>08909 - Livestock Exchange - Capital</b>								
0900 - Building Capital Works	\$ 10,300	\$ 29,717	0	5,000	0	0	5,000	100%
<b>69760 - Staff Vehicle Purchases</b>								
6800 - Plant Purchases	\$ 320,000	\$ 282,970	47,926	320,000	290,716	320,000	29,284	9%
<b>69860 - Works Plant Purchases</b>								
6800 - Plant Purchases	\$ 740,000	\$ 825,708	372,827	900,000	563,746	900,000	336,254	37%
<b>Total</b>	<b>\$ 6,789,954</b>	<b>\$ 7,348,186</b>	<b>\$ 931,926</b>	<b>\$ 7,586,201</b>	<b>\$ 5,935,558</b>	<b>\$ 8,262,231</b>	<b>\$ 1,650,643</b>	<b>22%</b>

**YARRIAMBIACK SHIRE COUNCIL**  
**BALANCE SHEET**  
**AS AT 31st MARCH 2016**

	2014/2015 Budget	2014/2015 Actuals	March Actuals	2015/2016 Budget	YTD Actuals	Forecast	YTD Variance	YTD % Variance
<b>Current Assets</b>								
Cash & Cash Equivalents Investments	\$ 2,992,000	\$ 4,322,000	\$ (1,837,697)	\$ 1,429,000	\$ 5,256,669	\$ 1,429,000	\$ (3,827,669)	(268%)
Rate Debtors	\$ 900,000	\$ 1,185,000	\$ (193,699)	\$ 850,000	\$ 2,085,378	\$ 850,000	\$ (1,235,378)	(145%)
Debtors	\$ 511,000	\$ 407,000	\$ (21,093)	\$ 94,000	\$ 303,419	\$ 94,000	\$ (209,419)	(223%)
Other Current Accrued Assets	\$ 180,000	\$ 206,000	\$ 4,056	\$ 180,000	\$ 17,096	\$ 180,000	\$ 162,904	91%
Inventory On Hand	\$ 900,000	\$ 484,000	\$ 45,958	\$ 711,000	\$ 517,680	\$ 711,000	\$ 193,320	27%
Assets Held for Resale	\$ 84,000	\$ 31,000	\$ -	\$ 15,000	\$ 31,320	\$ 15,000	\$ (16,320)	(109%)
<b>Current Assets Total</b>	<b>\$ 5,567,000</b>	<b>\$ 6,635,000</b>	<b>\$ (2,002,475)</b>	<b>\$ 3,279,000</b>	<b>\$ 8,211,562</b>	<b>\$ 3,279,000</b>	<b>\$ (4,932,562)</b>	
<b>Non Current Assets</b>								
Non Current Debtors	\$ -	\$ 1,000	\$ -	\$ -	\$ 609	\$ -	\$ (609)	0%
Investments	\$ 350,000	\$ 481,000	\$ -	\$ 357,000	\$ 480,752	\$ 357,000	\$ (123,752)	(35%)
Fixed Assets	\$ 149,645,000	\$ 154,054,000	\$ 931,926	\$ 159,177,000	\$ 159,991,344	\$ 159,177,000	\$ (814,344)	(1%)
<b>Non Current Assets Total</b>	<b>\$ 149,995,000</b>	<b>\$ 154,536,000</b>	<b>\$ 931,926</b>	<b>\$ 159,534,000</b>	<b>\$ 160,472,705</b>	<b>\$ 159,534,000</b>	<b>\$ (938,705)</b>	
<b>TOTAL ASSETS</b>	<b>\$ 155,562,000</b>	<b>\$ 161,171,000</b>	<b>\$ (1,070,549)</b>	<b>\$ 162,813,000</b>	<b>\$ 168,684,267</b>	<b>\$ 162,813,000</b>	<b>\$ (5,871,267)</b>	
<b>Current Liabilities</b>								
Creditors	\$ (1,200,000)	\$ (2,070,000)	\$ (238,479)	\$ (1,200,000)	\$ (1,601,281)	\$ (1,200,000)	\$ 401,281	(33%)
Current Loans	\$ (151,000)	\$ (136,000)	\$ -	\$ (62,000)	\$ (135,973)	\$ (135,973)	\$ 73,973	(119%)
Short Term Provisions	\$ (2,619,000)	\$ (2,854,000)	\$ -	\$ (2,619,000)	\$ (2,828,416)	\$ (2,619,000)	\$ 209,416	(8%)
Trust & Deposits	\$ -	\$ (31,000)	\$ 1,782	\$ -	\$ (162,016)	\$ -	\$ 162,016	0%
<b>Current Liabilities Total</b>	<b>\$ (3,970,000)</b>	<b>\$ (5,091,000)</b>	<b>\$ (236,697)</b>	<b>\$ (3,881,000)</b>	<b>\$ (4,727,686)</b>	<b>\$ (3,954,973)</b>	<b>\$ 846,686</b>	
<b>Non Current Liabilities</b>								
Long Term Provisions	\$ (404,000)	\$ (519,000)	\$ -	\$ (404,000)	\$ (519,433)	\$ (404,000)	\$ 115,433	(29%)
Non Current Loans	\$ (199,000)	\$ (215,000)	\$ 25,018	\$ (229,000)	\$ (103,819)	\$ (229,000)	\$ (125,181)	55%
<b>Non Current Liabilities Total</b>	<b>\$ (603,000)</b>	<b>\$ (734,000)</b>	<b>\$ 25,018</b>	<b>\$ (633,000)</b>	<b>\$ (623,252)</b>	<b>\$ (633,000)</b>	<b>\$ (9,748)</b>	
<b>TOTAL LIABILITIES</b>	<b>\$ (4,573,000)</b>	<b>\$ (5,825,000)</b>	<b>\$ (211,679)</b>	<b>\$ (4,514,000)</b>	<b>\$ (5,350,938)</b>	<b>\$ (4,587,973)</b>	<b>\$ 836,938</b>	
<b>NET ASSETS</b>	<b>\$ (150,989,000)</b>	<b>\$ (155,346,000)</b>	<b>\$ 1,282,228</b>	<b>\$ (158,299,000)</b>	<b>\$ (163,333,329)</b>	<b>\$ (158,225,027)</b>	<b>\$ 5,034,329</b>	
<b>Current Assets</b>								
Accumulated Surplus/Deficit	\$ (64,189,000)	\$ (60,384,000)	\$ 1,275,659	\$ (58,941,000)	\$ (62,436,215)	\$ (58,867,027)	\$ 3,495,215	(6%)
Asset Revaluation Reserve	\$ (86,800,000)	\$ (94,962,000)	\$ -	\$ (99,358,000)	\$ (100,897,115)	\$ (99,358,000)	\$ 1,539,115	(2%)
<b>TOTAL EQUITY</b>	<b>\$ (150,989,000)</b>	<b>\$ (155,346,000)</b>	<b>\$ 1,275,659</b>	<b>\$ (158,299,000)</b>	<b>\$ (163,333,329)</b>	<b>\$ (158,225,027)</b>	<b>\$ 5,034,329</b>	

**YARRIAMBIACK SHIRE COUNCIL**

**Investments**

Bendigo Bank	\$ 325,769.81	2.60%	01/09/2016
Commonwealth Bank	\$ 129,070.64	2.35%	19/07/2016
AMP (oncall)	\$ 510.39		Oncall
<b>\$</b>	<b>455,350.84</b>		

**Loans**

	Term & Rate	Finish Date
National Australia Bank - Unfunded Superannuation	\$ 264,810 Fixed at 5.21%	30/06/2018
<b>\$</b>	<b>264,810</b>	

# Rates Report - April 2016

Prepared by Chantelle Pitt

Rate Code	Ward Description	Total Income	Rebate Total	Receipts	Total
General Rates	Dunmunkle	\$ 3,172,640.94	\$ (47,775.35)	\$ (2,648,308.44)	\$ 476,557.15
	Hopetoun	\$ 3,446,034.54	\$ (37,189.56)	\$ (2,987,204.25)	\$ 421,640.73
	Warracknabeal	\$ 4,206,484.29	\$ (60,537.68)	\$ (3,590,026.76)	\$ 555,919.85
<b>Total</b>		<b>\$ 10,825,159.77</b>	<b>\$ (145,502.59)</b>	<b>\$ (9,225,539.45)</b>	<b>\$ 1,454,117.73</b>
120L Residential Garbage Service	Dunmunkle	\$ 144,521.44	\$ (9,265.56)	\$ (86,284.99)	\$ 48,970.89
	Hopetoun	\$ 120,718.31	\$ (7,091.04)	\$ (65,142.49)	\$ 48,484.78
	Warracknabeal	\$ 210,063.66	\$ (9,624.16)	\$ (132,785.90)	\$ 67,653.60
<b>Total</b>		<b>\$ 475,303.41</b>	<b>\$ (25,980.76)</b>	<b>\$ (284,213.38)</b>	<b>\$ 165,109.27</b>
120L Commercial Garbage Service	Dunmunkle	\$ 4,504.36	\$ -	\$ (3,958.06)	\$ 546.30
	Hopetoun	\$ 5,271.88	\$ -	\$ (4,152.28)	\$ 1,119.60
	Warracknabeal	\$ 4,560.84	\$ -	\$ (3,347.48)	\$ 1,213.36
<b>Total</b>		<b>\$ 14,337.08</b>	<b>\$ -</b>	<b>\$ (11,457.82)</b>	<b>\$ 2,879.26</b>
120L Rural Garbage Service	Dunmunkle	\$ 4,487.92	\$ (109.65)	\$ (3,940.06)	\$ 438.21
	Hopetoun	\$ 2,336.32	\$ -	\$ (1,834.68)	\$ 501.64
	Warracknabeal	\$ 6,078.24	\$ (55.81)	\$ (5,127.75)	\$ 894.68
<b>Total</b>		<b>\$ 12,902.48</b>	<b>\$ (165.46)</b>	<b>\$ (10,902.49)</b>	<b>\$ 1,834.53</b>
240L Residential Garbage Service	Dunmunkle	\$ 6,446.57	\$ (309.12)	\$ (4,851.14)	\$ 1,286.31
	Hopetoun	\$ 7,533.42	\$ (387.45)	\$ (4,243.04)	\$ 2,902.93
	Warracknabeal	\$ 23,583.84	\$ (604.36)	\$ (17,240.79)	\$ 5,738.69
<b>Total</b>		<b>\$ 37,563.83</b>	<b>\$ (1,300.93)</b>	<b>\$ (26,334.97)</b>	<b>\$ 9,927.93</b>
240L Commercial Garbage Service	Dunmunkle	\$ 42,505.63	\$ -	\$ (28,366.01)	\$ 14,139.62
	Hopetoun	\$ 32,833.11	\$ -	\$ (28,067.46)	\$ 4,765.65
	Warracknabeal	\$ 98,838.74	\$ -	\$ (85,607.56)	\$ 13,231.18
<b>Total</b>		<b>\$ 174,177.48</b>	<b>\$ -</b>	<b>\$ (142,041.03)</b>	<b>\$ 32,136.45</b>
240L Rural Garbage Service	Dunmunkle	\$ 10,199.52	\$ -	\$ (9,161.64)	\$ 1,037.88
	Hopetoun	\$ 9,491.18	\$ -	\$ (8,152.65)	\$ 1,338.53
	Warracknabeal	\$ 20,403.34	\$ -	\$ (19,561.09)	\$ 842.25
<b>Total</b>		<b>\$ 40,094.04</b>	<b>\$ -</b>	<b>\$ (36,875.38)</b>	<b>\$ 3,218.66</b>
80L Residential Garbage Service	Dunmunkle	\$ 31,365.06	\$ (2,108.42)	\$ (17,549.73)	\$ 11,706.91
	Hopetoun	\$ 32,727.96	\$ (2,468.47)	\$ (17,598.07)	\$ 12,661.42
	Warracknabeal	\$ 38,735.68	\$ (1,902.42)	\$ (24,540.88)	\$ 12,292.38
<b>Total</b>		<b>\$ 102,828.70</b>	<b>\$ (6,479.31)</b>	<b>\$ (59,688.68)</b>	<b>\$ 36,660.71</b>
80L Rural Garbage Service	Dunmunkle	\$ 1,118.56	\$ -	\$ (1,048.64)	\$ 69.92
	Hopetoun	\$ 838.92	\$ -	\$ (699.10)	\$ 139.82
	Warracknabeal	\$ 3,495.50	\$ (45.48)	\$ (3,338.47)	\$ 111.55
<b>Total</b>		<b>\$ 5,452.98</b>	<b>\$ (45.48)</b>	<b>\$ (5,086.21)</b>	<b>\$ 321.29</b>
Residential Kerbside Recycling	Dunmunkle	\$ 118,778.05	\$ (7,979.75)	\$ (72,729.81)	\$ 38,068.49
	Hopetoun	\$ 101,818.95	\$ (6,926.75)	\$ (61,382.20)	\$ 33,510.00
	Warracknabeal	\$ 174,170.15	\$ (8,116.30)	\$ (114,709.60)	\$ 51,344.25
<b>Total</b>		<b>\$ 394,767.15</b>	<b>\$ (23,022.80)</b>	<b>\$ (248,821.61)</b>	<b>\$ 122,922.74</b>
Commercial Kerbside Recycling	Dunmunkle	\$ 10,600.86	\$ -	\$ (7,784.20)	\$ 2,816.66
	Hopetoun	\$ 8,316.87	\$ -	\$ (7,522.51)	\$ 794.36
	Warracknabeal	\$ 16,082.26	\$ -	\$ (13,778.61)	\$ 2,303.65
<b>Total</b>		<b>\$ 34,999.99</b>	<b>\$ -</b>	<b>\$ (29,085.32)</b>	<b>\$ 5,914.67</b>
Rural Kerbside Recycling	Dunmunkle	\$ 2,115.72	\$ (27.45)	\$ (1,923.80)	\$ 164.47
	Hopetoun	\$ 1,894.43	\$ -	\$ (1,639.32)	\$ 255.11
	Warracknabeal	\$ 1,504.80	\$ (24.42)	\$ (1,480.38)	\$ -
<b>Total</b>		<b>\$ 5,514.95</b>	<b>\$ (51.87)</b>	<b>\$ (5,043.50)</b>	<b>\$ 419.58</b>
Municipal Charge	Dunmunkle	\$ 125,301.75	\$ (5,263.40)	\$ (79,769.24)	\$ 40,269.11
	Hopetoun	\$ 146,362.45	\$ (4,669.28)	\$ (81,657.13)	\$ 60,036.04
	Warracknabeal	\$ 180,802.22	\$ (5,364.17)	\$ (116,229.00)	\$ 59,209.05
<b>Total</b>		<b>\$ 452,466.42</b>	<b>\$ (15,296.85)</b>	<b>\$ (277,655.37)</b>	<b>\$ 159,514.20</b>
SDL/Bins/Fire/Old Municipal Charge	Dunmunkle	\$ 6,492.77	\$ -	\$ (463.17)	\$ 6,029.60
	Hopetoun	\$ 4,667.06	\$ -	\$ -	\$ 4,667.06
	Warracknabeal	\$ 5,310.18	\$ -	\$ -	\$ 5,310.18
<b>Total</b>		<b>\$ 16,470.01</b>	<b>\$ -</b>	<b>\$ (463.17)</b>	<b>\$ 16,006.84</b>
Credits	Dunmunkle	\$ -	\$ -	\$ (14,979.21)	\$ (14,979.21)
	Hopetoun	\$ -	\$ -	\$ (10,641.65)	\$ (10,641.65)
	Warracknabeal	\$ -	\$ -	\$ (11,090.36)	\$ (11,090.36)
<b>Total</b>		<b>\$ -</b>	<b>\$ -</b>	<b>\$ (36,711.22)</b>	<b>\$ (36,711.22)</b>
Fire Services Fixed Charge	Dunmunkle	\$ 230,455.51	\$ (16,850.00)	\$ (161,221.69)	\$ 52,383.82
	Hopetoun	\$ 264,208.85	\$ (12,400.00)	\$ (181,782.70)	\$ 70,026.15
	Warracknabeal	\$ 334,011.18	\$ (19,550.00)	\$ (237,916.17)	\$ 76,545.01
<b>Total</b>		<b>\$ 828,675.54</b>	<b>\$ (48,800.00)</b>	<b>\$ (580,920.56)</b>	<b>\$ 198,954.98</b>
Fire Services Levy	Dunmunkle	\$ 137,670.05	\$ -	\$ (124,740.41)	\$ 12,929.64
	Hopetoun	\$ 163,047.18	\$ -	\$ (150,170.73)	\$ 12,876.45
	Warracknabeal	\$ 185,383.33	\$ -	\$ (171,064.87)	\$ 14,318.46
<b>Total</b>		<b>\$ 486,100.56</b>	<b>\$ -</b>	<b>\$ (445,976.01)</b>	<b>\$ 40,124.55</b>
<b>Grand Total</b>		<b>\$ 13,906,814.39</b>	<b>\$ (266,646.05)</b>	<b>\$ (11,426,816.17)</b>	<b>\$ 2,213,352.17</b>

% Outstanding of Current Rates & Charges

15.92%

% Outstanding 2015

15.45%

% Outstanding 2014

14.18%

% Outstanding 2013 No April Report

## Recommendation

That the report be received.